

ASSOCIATION OF PROFESSIONAL LANDSCAPE DESIGNERS

the designer

2024 Awards Issue

DESIGNER OF THE YEAR

Katherine Field,
Katherine Field & Associates, Inc.
Fen's Edge, Westerly, Rhode Island

2024 APLD International Landscape
Design Awards

table of contents

2024 APLD INTERNATIONAL LANDSCAPE DESIGN AWARDS

The Judges	3
Designer Of The Year	6
Best of Show	10
Residential \$25,000 - \$100,000	17
Residential Over \$100,000	33
Planting Design	77
Non-Residential \$100,000 - \$500,000	86
Non-Residential Over \$500,000	89
Show Gardens	95
Small Gardens	103
Specialty Projects	113
Board of Directors	121

The 2024 International Landscape Design Award winners presented design ideas exceeding fundamental conceptual boundaries while encompassing space, serenity, and sustainability. All the designs are works of aspiration and excellence. Enjoy these highlights of the winning projects.

the judges

2024 APLD International Landscape Design Awards Distinguished Judges



Karolee Brown



Bruce Crawford



Lisa Nunamaker, PLA



Tina Nyce

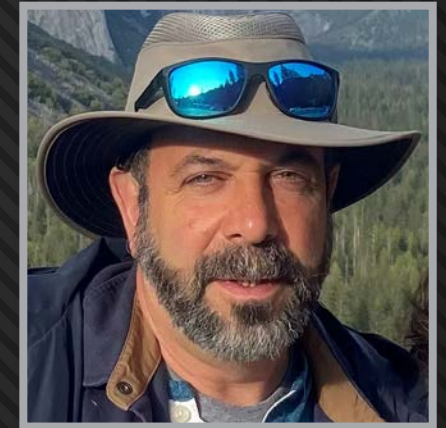

Richard Rosiello



Susie Thompson, CPLD, FAPLD



Katie Weber, CPLD

2024 apld international landscape
designer of the year



designer of the year

FEN'S EDGE

Residential Category Over \$100,000
Project Location: Westerly, Rhode Island
Zone: 6b

Designer of the Year, Katherine Field, Katherine Field & Associates, Inc.

Website: katherinefield.com
Firm Location: Newport, Rhode Island



PHOTOGRAPH BY ANTHONY CRISAFULLI PHOTOGRAPHY

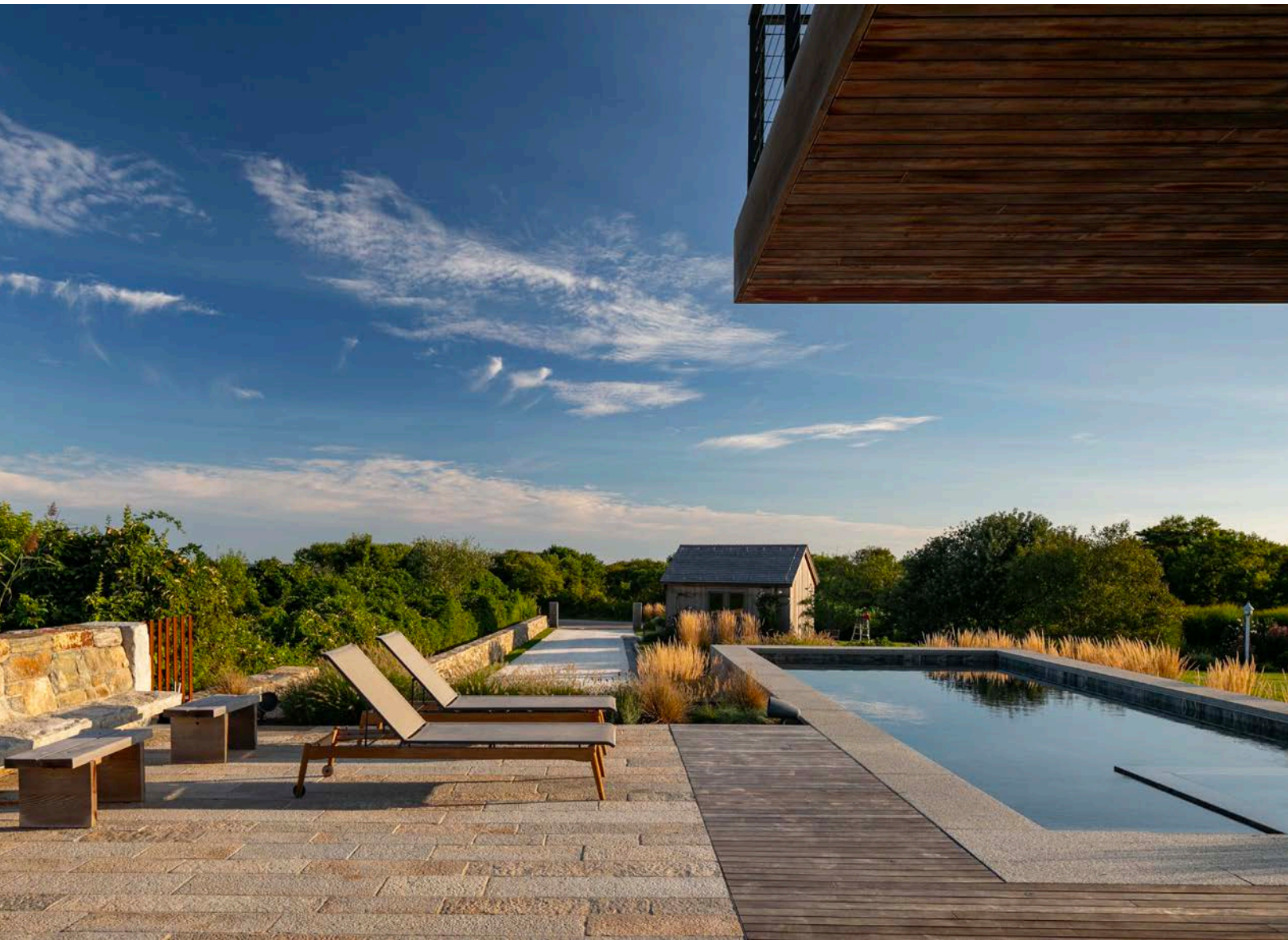

Integrating the rugged allure of a seaside nature preserve with the energy of cantilevered structural architecture challenged Katherine Field and her team to create a seamless transition between interior and exterior spaces.

On a long, narrow lot in coastal Rhode Island, 2024 Landscape Designer of the Year Katherine Field blended the clean lines of her clients' new home into a delightful landscape with artistic, natural touches in her design, "Fen's Edge."

Following the development of a modern beach home at the top of their sloping property, Field's clients sought a picturesque landscape that would connect them with the natural beauty surrounding their property. The owners recognized that the home's large picture windows and inviting patios would draw attention outdoors, so they pursued Field's expertise as Chief Creative Officer & Principal of Kathrine Field & Associates, Inc. to create a scene worth joining. The property's architecture, sloped topography, surrounding landscape and seaside location presented intriguing challenges, which Field and her team turned into compelling design opportunities.

The scope of the project included a new pool and integrated spa, a kitchen and cutting garden, a Zen Garden, a custom outdoor fireplace, a custom outdoor shower, a Corten Steel installation, stone walls, entry posts and plaques and overall site lighting and planting.

Judges praised Field's site plan and the emotions it invokes.

"When a design makes you say 'Wow!' it's got to be special," said one judge. "This design... has well-defined garden rooms, incredibly rich materials, plus amazing beds overflowing with plants. The designer did a wonderful job of considering the 'place' and making sure elements of the site, plants and culture were woven throughout."

"A very nice plan," said another judge. "This project emits emotion, which every great landscape should. The elements of stone and steel moving within the space are lovely... I would be thrilled to own this landscape."

"With the architectural changes, the gardens and landscape are stellar. The site grade changes were handled well with functional and attractive site areas," another judge stated. "Materials and forms are excellent; a work of art."

The Inspiration

Field makes multiple site visits when planning a design. The insights she gleans there, paired with her extensive studies and experiences, guide her design process.

In this design, Field gleaned inspiration from the home's architecture, the surrounding landscape and the nearby beaches of Rhode Island. However, the landscape remained the team's "primary geometry" or guiding principle, she explained. "We were doing everything to have the natural landscape – which we could not change – accent what we were doing and vice versa, so that our work would enhance the natural," said Field. "We did not do anything that became... a barrier to the visual experience that extended from the house through our landscape area and right out into the natural area."

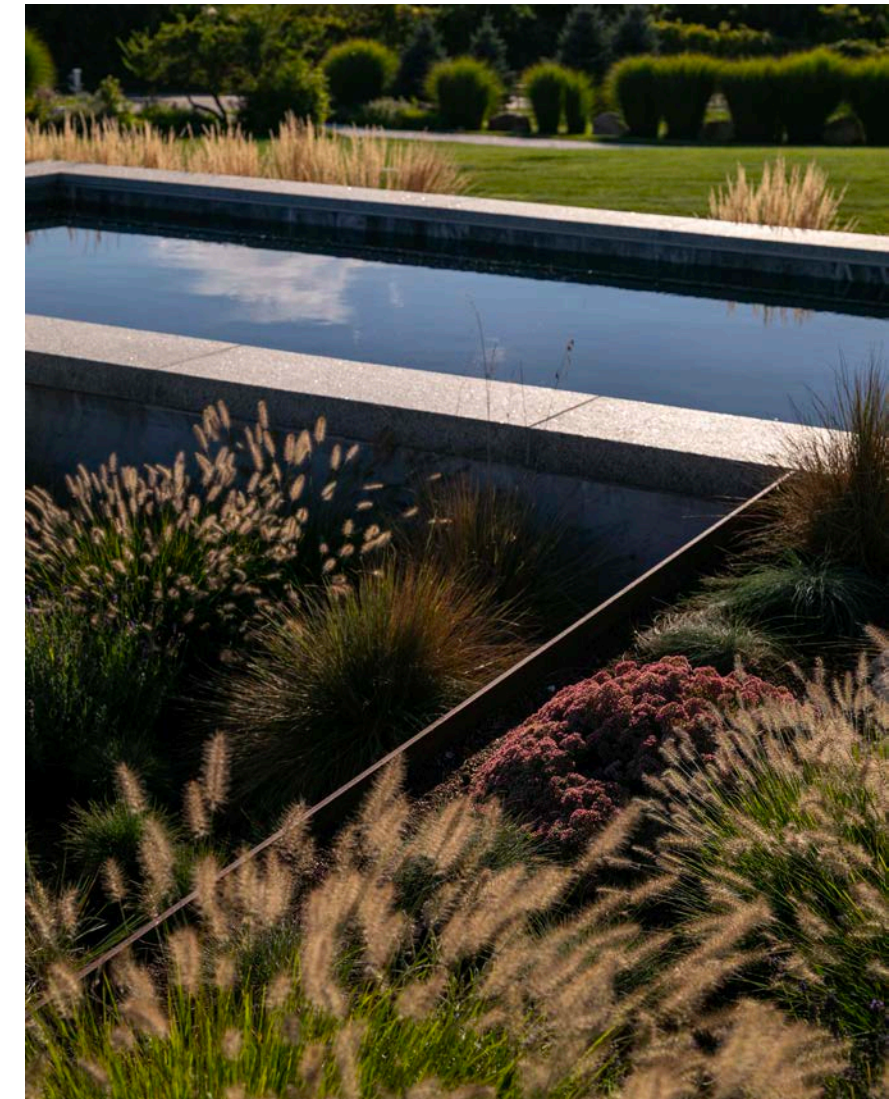

PHOTOGRAPH BY ANTHONY CRISAFULLI PHOTOGRAPHY

designer of the year

Understanding her clients and their desires also fueled Field's inspiration.

"We want our clients to have the best experience and to have them fall in love with nature," said Field. "If they can have that moment where the sun's just right and they feel it on their face, and a... cooling breeze and hear certain kinds of birds because we created a habitat for them. That is the fourth dimension of our work."

Embracing the Grade

Grades add complexity to projects, especially when working in a fragile, seaside environment.

"The grade was a real defining factor for how this landscape sat relative to the building," said Field. Field's team embraced the grade by imagining three terracing levels: the driveway/parking, the pool terrace and the main entryway.

"The idea that there were these thrusting structural elements to the architecture sort of set us in the idea that the pool itself could be that same form, could have that same energy," said Field. "We minimized the amount of walls and pathways around the pool and just had it be as if it were that cantilevered terrace above."



PHOTOGRAPH BY ANTHONY CRISAFULLI PHOTOGRAPHY

The pool terrace, containing both pool and spa, travels out of the natural slope away from the house, mirroring the architecture of the house. Field's team then utilized board form concrete walls around the pool to create another connection to the modern architecture.

Breaking up the grade with multiple sets of stairs accented by Corten Steel opened perspectives to the accompanying gardens and terraces. The varied native plantings along the walkway softened the modern lines, fostering an inviting connection with the earth.

Runoff from the roof and hardscapes and overall drainage had to be carefully managed to minimize disruption to the fragile environment. To address this issue, Field's team directed the water to a rain garden at the bottom of the site, planted with natives that gradually transitioned to a natural plant mix at the street level.



PHOTOGRAPH BY ANTHONY CRISAFULLI PHOTOGRAPHY

Designing Next to "The Fen"

Field's clients loved the neighboring property – a wild, beautiful protected landscape known as "The Fen."

Bordering "The Fen" and other traditional beach homes with little delineation between properties elevated the importance of blending the client's modern aesthetic with the seaside environment. Field's team responded by pulling natural patterns and colors into design elements and materials to create a seamless transition.

Designing "Fen's Edge" and the conservation's setback requirements also shaped aspects of the design – particularly the outdoor shower.

Field and the architect discovered a fitting solution by overhanging a fully cantilevered outdoor shower in the setback. To unite it with the house and the surrounding natural landscape, her team used a bronze shower enclosure to match the house and frosted glass panels to let in light while maintaining privacy.

Unifying Element of Corten Steel

Using Corten Steel to unify the design throughout the site added accents that both break down the scale and beautifully change the experience over time.

Field and her team used the material in a variety of artful ways. For the fireplace, they separated two sheets of Corten giving the feature a warm glow. Corten Steel highlighted entry post plaques, cutting garden beds and terraces, bent path lights and retaining "walls" throughout the slope to break up the stairway leading to the main entry.

Field also used Corten Steel in the pool fence design, which has a special story. Her initial inspiration came from the dune fencing along Rhode Island beaches, but she ran into a quandary as the pool terrace extended out.

PHOTOGRAPH BY MICHAEL J. LEE PHOTOGRAPHY



"The grade dropped off and at a certain point, you had a natural four-foot high pool enclosure wall. The pool enclosure fencing... started to devolve into what you will see on the beach, missing pickets and at an angle. [It] became a very abstract design element," shared Field.

She wasn't sure how to space the fence or what height to give its pickets. As she worked, music was playing.

"I kept singing. I kept imagining [my clients] out there. It's beautiful sunshine. And so I took the musical notes from 'Good Day Sunshine,' the Beatles song and [placement of the notes became] the spacing."

Field's clients love the look and the special meaning behind the installation.

Advice for Aspiring Designers

Field strongly advocates for aspiring professionals to obtain their landscape architecture licensure because of the knowledge and immense value it provides.

When designing, Field encouraged designers to lean into the process: "Lean into your project and make every moment in connection mean something," she said. "And always be of the mind and heart of your clients. Experience this for them way before they ever step foot on it."

Develop trusted relationships with tradespeople. If you don't have a team that's been on-boarded, make appointments and visit their shops, Field encouraged. "I much prefer to bring [the tradespeople] all together... and learn from them what the opportunities and constraints are so that your design is not in a vacuum. You're respecting the skill sets that they have."

The devil can be in the details, so Field encourages being present during all of the placement of details to ensure it is done right.

Embrace challenges as opportunities: "Don't be afraid when you come up to a roadblock or if you think something's too hard. Just lean in because that's where the best design comes," said Field.

Acknowledgments

Field feels humbled and grateful for the award and highly praised her team: "Knowing that the work they're doing has been recognized and is being given and honor is just so important for them."

She also thanked project collaborators for their contributions to the design's success.



2024 apld international landscape design
best of show

best of show

WESTSIDE DIABLO

Residential Category Over \$100,000
Project Location: Alamo, California
Zone: 9b

Best of Show David Thorne Landscape Architect, Inc. Design Team: David Thorne, Elise Marie Heikkinen, Kristina Kessel & Kenieffer Vargas

Website: www.thornela.com
Firm Location: Oakland, California

PHOTOGRAPHS BY PAUL DYER PHOTOGRAPHY



A 29' grade change. Protected trees. A drought-prone climate. Any of these could give a designer nightmares. Instead, David Thorne's team tamed the design diablos into a stunning, functional success.

In the misty hills of California, under an oak tree canopy, 2024 Best of Show winner David Thorne, Principal/Owner and Founder of David Thorne Landscape Architect (DTLA), and his team transformed a dated, concrete and red brick landscape into a breathtaking masterpiece titled "Westside Diablo."

Thorne was tasked with renovating an outdated landscape into sophisticated, family-friendly areas that fit the personality of the clients, their active, young children and pets.

The complex project encompassed reconfiguring a retaining wall, creating more space for an upper terrace, updating guard rails, building a custom fountain, designing floating stairs with expanded landings, updating an outdated pool and deck, adding a fire feature, buffet counter, outdoor shower and spa and planting design.

Judges were impressed with the exquisite transformation of the challenging site, complementing material usage, spatial division and scaling and blending of spaces.



"The before is hard to believe with the after photos," said a judge. "Design and development – a paradise with views."

"The stair sequence is a thing of dreams," another judge shared. "Users are transported through the tree tops while minimizing impact to the tree roots. The established trees offer history and a sense of place."

"Selected materials beautifully update the elements and surrounds... Layered plantings, including many natives, completes the connection of spaces," praised another judge. "Superb execution, attention to detail and fulfillment of client's wish list."

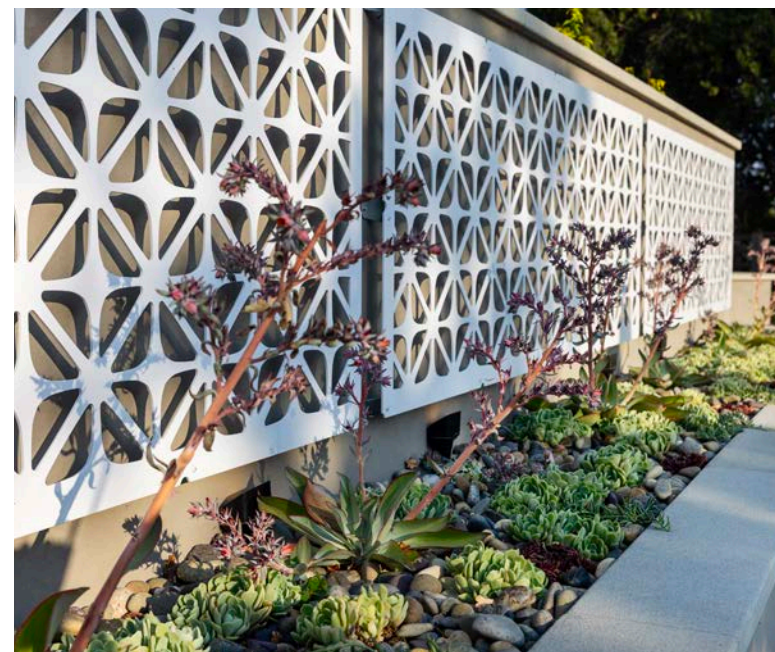

Inspiring the Design

The client's interest, passion and drive heightened the creativity of Thorne's team.

"We had a very unique client... [who] really wanted something no one else had. She kept pushing us to be as creative as possible – not only in the big ideas but also in the individual details of the design," said Thorne. "We were really inspired to modernize it and make it a very special environment to suit their personality and lifestyle."

The site, perched on the top of a hill with beautiful views of Mount Diablo, had both significant potential and constraints that demanded creativity.

"There were a lot of challenges to overcome," said Thorne. "For a lot of projects, everything is kind of flat... This [project had] so much topography that you're really viewing this lower pool area from above. So, we wanted to make sure that it looks fantastic from above... and hangs together as an art piece."

Appeal of the Upper Terrace

After reconfiguring the existing retaining wall to offer a patio space for parties and a lawn for kicking a soccer ball, Thorne's team bordered the lawn with custom iron guardrails.

A walkway of large, bright white pavers leads guests past a custom-made fountain, a beloved feature of the client and Thorne's team.

"The whole office has a soft spot for the fountain," explained Thorne. "We designed it and contracted board and place concrete, then added some copper scuppers and spouts, into the design. It's an amazing little feature."

The youngest clients agree, enjoying the feature as a bath from time to time.

Overcoming the Slope

Descending from the upper terrace to the lower pool terrace is a whopping slope that is about five playground slides long. Finding a way to connect the two spaces while not making the trip below an uncomfortable trek was a feat.

"The biggest design challenge that necessitated the most creativity on this project was the staircase that leads from the upper terrace down to the pool area," said Quintana Kardel, Director of Operations at DTLA.



best of show



“A daunting 29 feet of grade change and a lot of existing native oak trees... [made us] question how to make this program element safe, functional and beautiful, along with respecting... the existing site conditions as much as possible.”

The solution emerged as a floating staircase descending into the oak canopy. A series of landings offered moments to pause and become immersed in the experience.

To build the floating stairway, Thorne’s team designed footings that made a minimal impact on the protected oak trees’ root structure and the slope.

Thermory, a thermally modified timber with lightweight, long-lasting properties, was selected to blend into the natural canopy and lessen the weight on the slope.

For the railings, Thorne selected dark-colored powder-coated metal to blend into the shadows. He credits his father’s fascination with how light hits differently on rotating steel columns with the inspiration for this decision.

A Breathtaking Poolscape

Descending from the tree canopy showcases the drastic transformation of the poolscape from an aerial perspective. The view showcases the clean, contemporary lines of the upgraded pool and deck. The crisp colors of the design are complemented by warm woods.

“I’m most proud of the pool area. I think the visual impact of the pool [when] seen below, with modern materials and the white tile extending out through the stairs... It’s a total transformation,” said Thorne.

The pool space offers everything one may need to enjoy a full day – including the fire feature, buffet, outdoor shower and spa. Large pavers running along one side of the pool echo the walkway on the upper terrace, uniting the two spaces.

Choosing Plantings for the Climate and Sustainability

One of the ways Thorne and his team soften their designs is through plantings. While this part of California is mostly a temperate climate, it has been growing increasingly hotter and drought-prone.



“We might not get rain for six months, so that makes the plant selection very challenging,” said Thorne. “To respond to that, we prioritize mainly native. There are some spots of color, but it’s a drought-resistant palate, especially in those areas of the native oaks.”

Because the clients have a young family, a lawn and recreational space on the upper terrace were important. Thorne’s team incorporated space for the client but kept it to a minimum. They also included a small lawn on the lower pool terrace.

“The use of native plants, really minimizing the lawn... and keeping those mature, beautiful trees healthy were all top of mind as we came up with our design solutions,” said Kardel. “The irrigation system is all in-line, drip irrigation, which is much more efficient and water-wise as well.”

Winning Best of Show

“I’m really thrilled to win the award this year. It’s a jury of our peers... so, to win this one elevates the smiles in our office,” shared Thorne.

“Behind every great design is a team of people including everyone at DTLA that worked on this project, our amazing collaborators, Ecliptic Landscape, Aquapool Construction and Lafayette Ironworks for the custom metalwork,” said Thorne.

“[We also thank] our clients who really pushed us to think outside of the box and were a dream to work with, including their young daughter who showed a real interest in the process.”

Advice for Emerging Designers

- **Document your work**
Thorne encourages using the highest quality photography you can afford. “Your images are so critical and are a passport to your future work. Invest in them accordingly and curate them carefully.”
- **Build your community**
“Develop deep relationships with whoever is leading the charge to assemble great design teams,” urged Thorne. “Your relationship with your clients is hugely important, but think bigger. The relationships you form with architects or interior designers or general contractors can be equally fruitful.”
- **Smaller, Softer, Newer Older**
Thorne’s team heard this mantra at a conference last year and embraced it.

“[It means] reduce hardscape and lawn whenever possible. Choose softer materials whenever possible (i.e. gravel versus concrete). Lean into newer sustainable technologies with materials. And reuse or recycle as many existing elements of the site as possible,” said Thorne.

“Have sustainability top of mind with all of your client interactions and subsequent designs. The urgency to find solutions to address the changing climate is something we all need to embrace.”



Thank you to all of our sponsors for your support!
We couldn't do it without you!

APLD Bronze Sponsors



COUNTRY CASUAL TEAK.



VECTORWORKS[®]
A NEMETSCHEK COMPANY

*Our sponsors spend their advertising dollars to reach YOU.
Please support our sponsors and consider recommending them to clients.*

2024 award winners

Residential

\$25,000 – \$100,000



gold award

OCEAN-LAKE HAVEN
Residential Category \$25,000 – \$100,000
Project Location: Asbury Park, New Jersey
Zone: 7b

Refugia Design
Website: www.refugiadesign.com
Firm Location: Narberth, Pennsylvania



JUDGES' FEEDBACK:
Aesthetic, environmental, and technical considerations seem fully maximized. Plant material is lush and connects the cottage to the water making the space seamless and harmonious. Appropriate materials upgrade the elements and provide an updated feel while keeping the lake cottage vibe. Kudos that some of the neighbors are following suit!



gold award

POPLAR CLOUD RESIDENCE

Residential Category \$25,000 – \$100,000

Project Location: Washington, DC

Zone: 7a/7b

Studio AKA

Website: www.studio-aka.com

Firm Location: Washington, DC

PHOTOGRAPHS BY THOMAS WALKER



JUDGES' FEEDBACK:

I'm a big fan of the dedication to straight natives, particularly in proximity to a national park. The result is not messy or neglected, but soft, lush, and well-placed. Use of the black locust and flagstones connects well to the new home. I love the connection to the park and that nothing impedes the view into it. I applaud the lack of water use and keeping roof runoff on site.

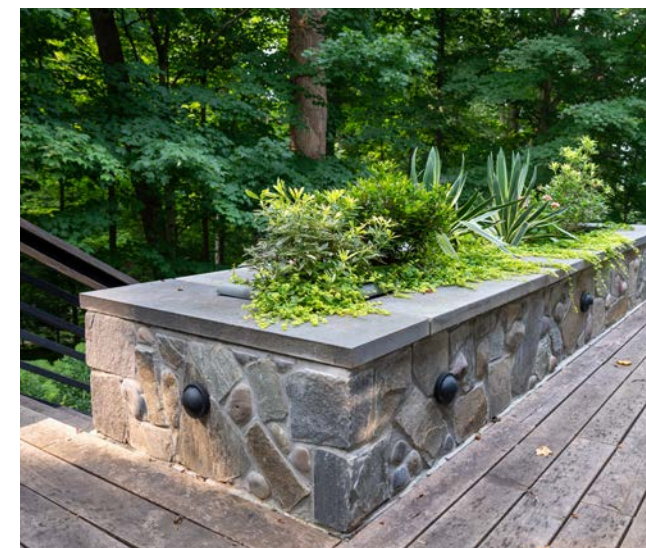
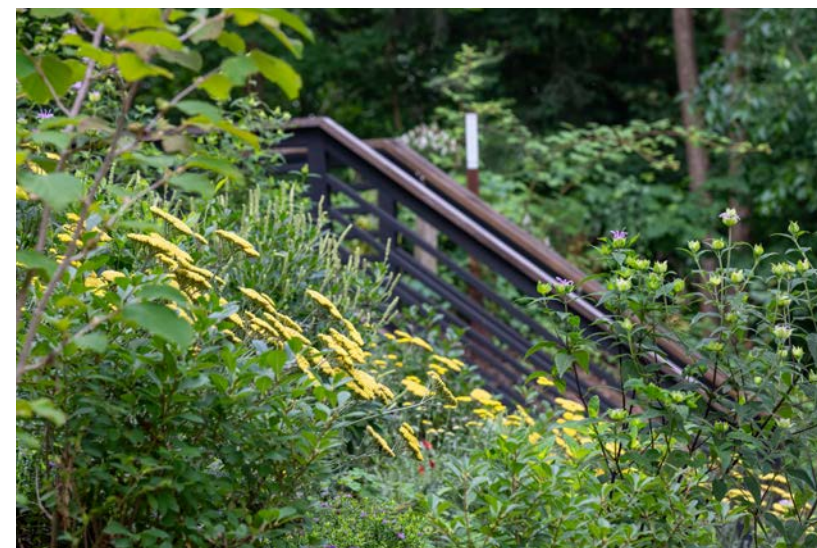

gold award

TIERED GREEN ENTRY

Residential Category \$25,000 – \$100,000

Project Location: Orinda, California

Zone: 9b

Katharine Webster Inc.

Website: www.webstermla.com

Firm Location: San Francisco, California

PHOTOGRAPHS BY CAITLIN ATKINSON



JUDGES' FEEDBACK:

This is an exquisite transformation that reflects teamwork and thoughtful, careful planning and design. The Corten and Ipe materials create an open and welcoming entry; it makes me want to slowly ascend the tiers and take in the surrounds on the way to the front door. The plantings knit everything together and provide a seamless connection between the architecture, garden and surrounds.

silver award

BACKYARD NATIVE HABITAT
Residential Category \$25,000 – \$100,000
Project Location: Takoma Park, Maryland
Zone: 7b

Kellie Cox & Strawberry Fields LLC

Website: www.strawberrygardendesign.com
Firm Location: Silver Spring, Maryland

PHOTOGRAPHS BY KELLIE COX

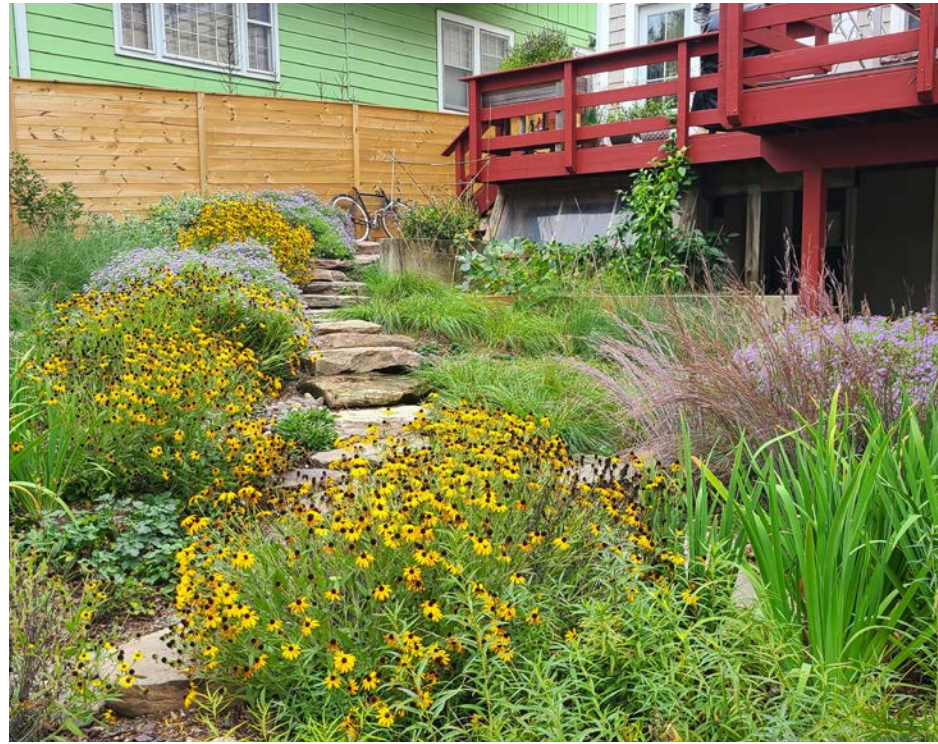

JUDGES' FEEDBACK:
Good spatial division with use of meandering step stone paths. The plant selection and color palette make a beautiful mosaic and invites wildlife. Replacing the lawn with mostly native plantings and making use of the neighbor's stormwater runoff demonstrates respect and concern for the environment!

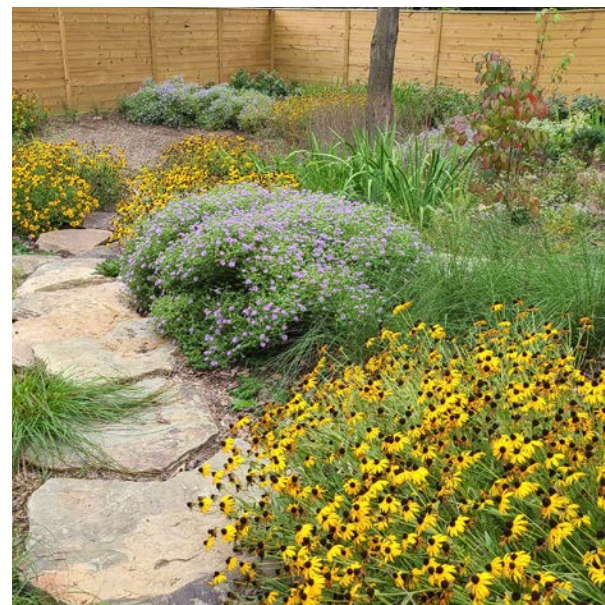

silver award



CALIFORNIA WABI SABI
Residential Category \$25,000 – \$100,000
Project Location: Albany, California
Zone: 10a

Mullein Designs

Website: www.mullein.designs.com
Firm Location: Berkeley, California

PHOTOGRAPHS BY JUDE PARKINSON MORGAN

JUDGES' FEEDBACK:
This is a beautiful transformation. There's very nice plant layering and textural quality in a limited space. The hardscape layout and enlarged planting spaces in the front provides a much more welcoming entry; the offset path to the front door improves the transition from street to house and gives a better sense of arrival. Spaces in the back are nicely integrated and proportioned reflecting spatial awareness. Vertical plantings soften the fence and give the space a cozy, private feel. Attention to detail is evident in this seamless, harmonized space that delivers the client's wishes.

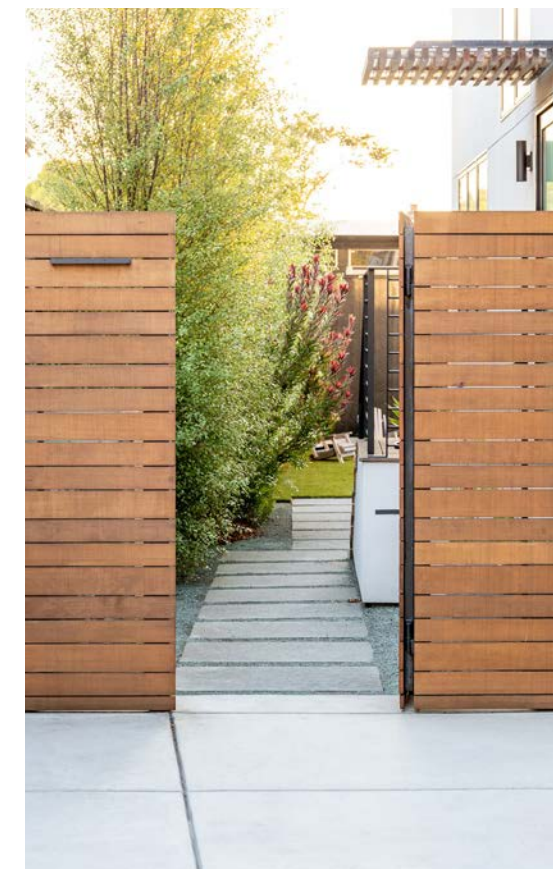

silver award



GOING NATIVE IN BELAIR
Residential Category \$25,000 – \$100,000
Project Location: Los Angeles, California
Zone: 10b

Urban Oasis Landscape Design

Website: www.urbanoasis-la.com
Firm Location: Los Angeles, California

PHOTOGRAPHS BY DEBORAH GLIKSMAN



JUDGES' FEEDBACK:

This is a successful design that takes great consideration of environmental impact while also creating an inviting, attractive, and functional space. I appreciate the water harvesting and fire-proof design choices. The four-season patio with the louvered pergola is accessible and a great refuge from the California heat while dining and cooking al fresco. I very much enjoy the Kurapia "lawn;" an environmentally friendly alternative to both artificial turf and traditional turf grass.

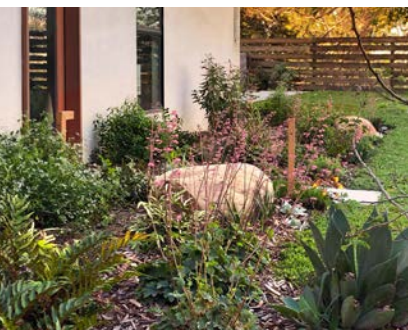

silver award



GRACIOUS ENTERTAINING
Residential Category \$25,000 – \$100,000
Project Location: Falls Church, Virginia
Zone: 7b

Lynley Ogilvie Landscape Design LLC

Website: www.lynleyogilvie.com
Firm Location: McLean, Virginia

PHOTOGRAPHS BY LYNLEY OGILVIE



JUDGES' FEEDBACK:

A well done and stunning transformation of space; this project lifts the visual appeal and function of the exterior space. I love the raised terrace with retaining walls, keeping the soils onsite reflecting respect for the environment. The resulting layers feel inviting and comfortable. Excellent material selection and impactful plantings blend the house into the surrounds creating a harmonious and seamless space.

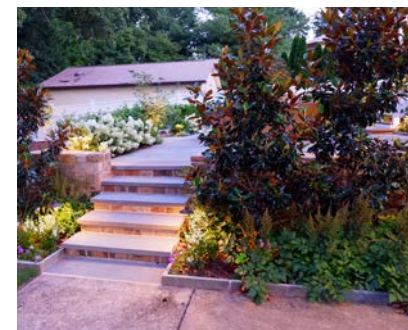
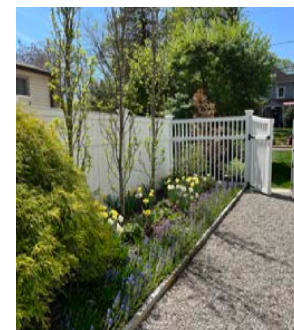

silver award



OLD WORLD CHARM

Residential Category \$25,000 – \$100,000
Project Location: Detroit, Michigan
Zone: 6

Great Lakes Landscape Design

Website: www.GreatLakesLandscapeDesign.com
Firm Location: Oak Park, Michigan



JUDGES' FEEDBACK:

This is a beautiful upgrade of the gardens. The addition of an address wall with layered plantings adds much needed definition to an entry that is far away from the house. The remake of the walkway to the 'front door' reflects thoughtful design and spatial awareness. Beautiful plant layering, textures, and color invite you in and lead you along in a seamless fashion. Materials are well chosen for the site and architecture creating a harmonious connection among the spaces.



silver award

RIPPLE RETREAT

Residential Category \$25,000 – \$100,000
Project Location: Sunnyvale, California
Zone: 9b

Blue Hibiscus Gardens

Website: www.BlueHibiscusGardens.com
Firm Location: Sunnyvale, California

PHOTOGRAPHS BY BLUE HIBISCUS GARDENS



JUDGES' FEEDBACK:

The existing, mature trees provide a beautiful canopy that gives the space a relaxing and cozy feel. The walkways offer easy circulation and divide the garden into nicely balanced spaces that flow together while accommodating the retained trees. The decks and patio are well done and nicely make use of the existing central tree as a focal point.

Tree protection, pond revitalization, and irrigation zones that maximize efficiency, show respect and concern for the environment. This is a beautiful and functional transformation that honors the client's requests.

silver award



SMALL ARLINGTON GARDEN
Residential Category \$25,000 – \$100,000
Project Location: Arlington, Virginia
Zone: 7b

Caroline Ervin Landscape Design LLC

Website: www.carolineervinlandscapedesign.com
Firm Location: Washington, D.C.



JUDGES' FEEDBACK:

This is a thoughtful and well-crafted design that considers many elements of the home, neighborhood, and region. I particularly like the trellis focal point and the fact that you can see it from the front door. I appreciate the flexibility of the design, how areas feel intimate while also working together for larger gatherings. The deck at first floor grade is a great extension of the living area and will accommodate those with limited mobility, allowing them access to the garden. The plant choices are in keeping with the traditional home and offer multiple seasons of interest.

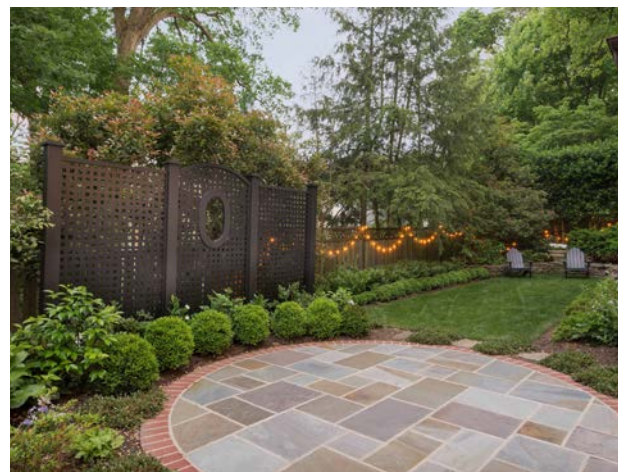

silver award

THE CIRCLES GARDEN
Residential Category \$25,000 – \$100,000
Project Location: Del Mar, California
Zone: 10b

Andrea Doonan Horticulture + Design

Website: www.AndreaDoonan.com
Firm Location: San Diego, California

PHOTOGRAPHS BY ANDREA DOONAN



JUDGES' FEEDBACK:

Replacing the most of the lawn with vegetation beautifully elevates the aesthetics of the space, making it more inviting, welcoming, and filled with opportunity for birds and other wildlife. It feels like it went from black and white to being in color: the monotonous lawn is now long sweeps of color and texture that follow the walls and existing curved lines.

The circular water feature enhances and adds functionality to the council ring, making it an even stronger focal point. The circle pavers seem to have a different energy and vibe than the rest of the garden. While functional as a walkway, they interrupt the long, flowing lines, and calm spaces that define the garden.

bronze award



PHOTOGRAPH BY AMY SURBER

WOODLAND'S EDGE

Residential Category \$25,000 – \$100,000
Project Location: Nashua, New Hampshire
Zone: 6a

Bill Parker & Parker Garden Design

Website: www.parkergarden.com
Firm Location: Nashua, New Hampshire



PHOTOGRAPH BY BARB YOUNG

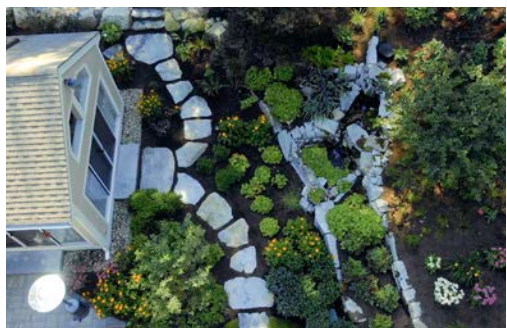

PHOTOGRAPH BY KELLER NUNLEY

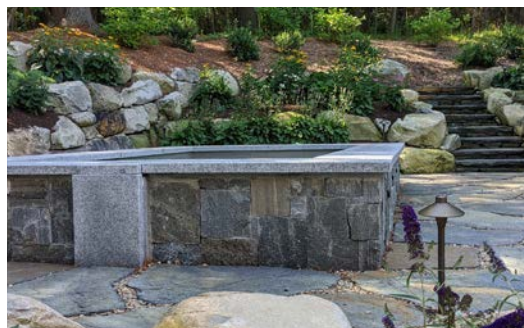

PHOTOGRAPH BY BARB YOUNG

JUDGES' FEEDBACK:

There are lovely elements within the design: patio, plunge pool, existing water feature that is a focal point, and nice stone paths through the garden area. The beautiful plantings are generous and nicely soften the rockery; as well as honors the woodland feel.

2024 award winners
Residential
Over \$100,000





PHOTOGRAPH BY VSI AERIAL LLC

JUDGES' FEEDBACK:

My heart stopped when I saw this project. The marriage of history, topography, stormwater management, and reusing of site materials is stunning in so many ways. This design is grounded in its location and beautifully inspired by it.

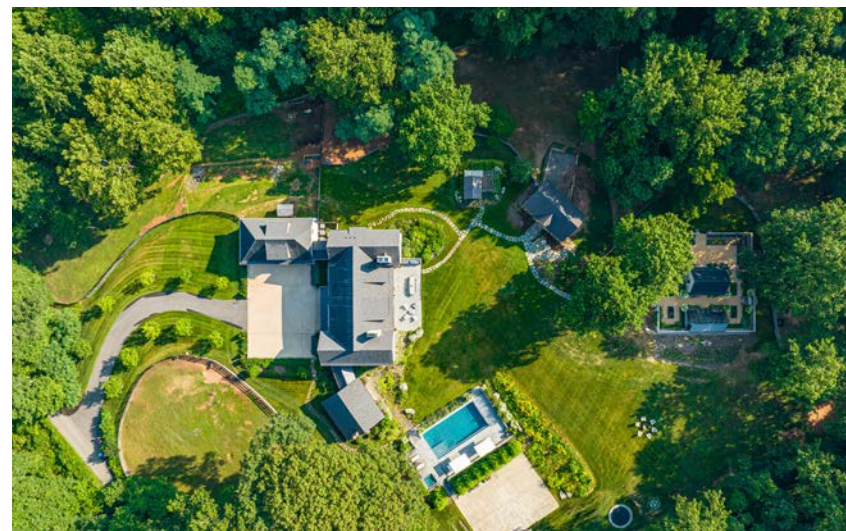

PHOTOGRAPH BY VSI AERIAL LLC



PHOTOGRAPH BY VSI AERIAL LLC



PHOTOGRAPH BY ALLEN RUSS PHOTOGRAPHY

gold award

BLUE SKY HILL
 Residential Category Over \$100,000
 Project Location: Vienna, Virginia
 Zone: 7a

Horn & Co.

Website: hornandco.com
 Firm Location: Arlington, Virginia



PHOTOGRAPH BY ALLEN RUSS PHOTOGRAPHY

gold award

FEZ WAY

Residential Category Over \$100,000
Project Location: Paradise Valley, Arizona
Zone: 9b

The Green Room Landscape Architecture

Website: tgrla.com
Firm Location: Phoenix, Arizona



PHOTOGRAPH BY JASON ROEHNER - ROEHNER PHOTOGRAPHS

JUDGES' FEEDBACK:

This planting design is amazing. Strong plant forms that make a statement with the architecture and within the site. I am especially drawn into the seating areas with the umbrella-like ironwood.



PHOTOGRAPH BY MICHAEL DUERINCKX PHOTOGRAPHY



PHOTOGRAPH BY JASON ROEHNER - ROEHNER PHOTOGRAPHS



PHOTOGRAPH BY MICHAEL DUERINCKX PHOTOGRAPHY



PHOTOGRAPH BY JASON ROEHNER - ROEHNER PHOTOGRAPHS

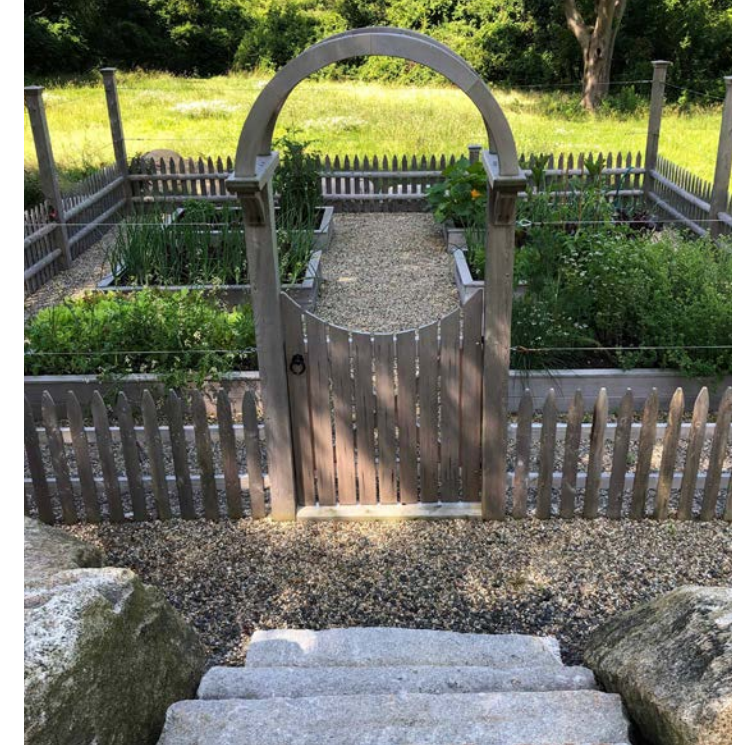

gold award

GLOUCESTER HARBOR HILLTOP

Residential Category Over \$100,000

Project Location: Gloucester, Massachusetts

Zone: 6b

Hilarie Holdsworth Design LLC

Website: www.hilarieholdsworthdesign.com

Firm Location: Gloucester, Massachusetts

PHOTOGRAPHS BY HILARIE HOLDSWORTH

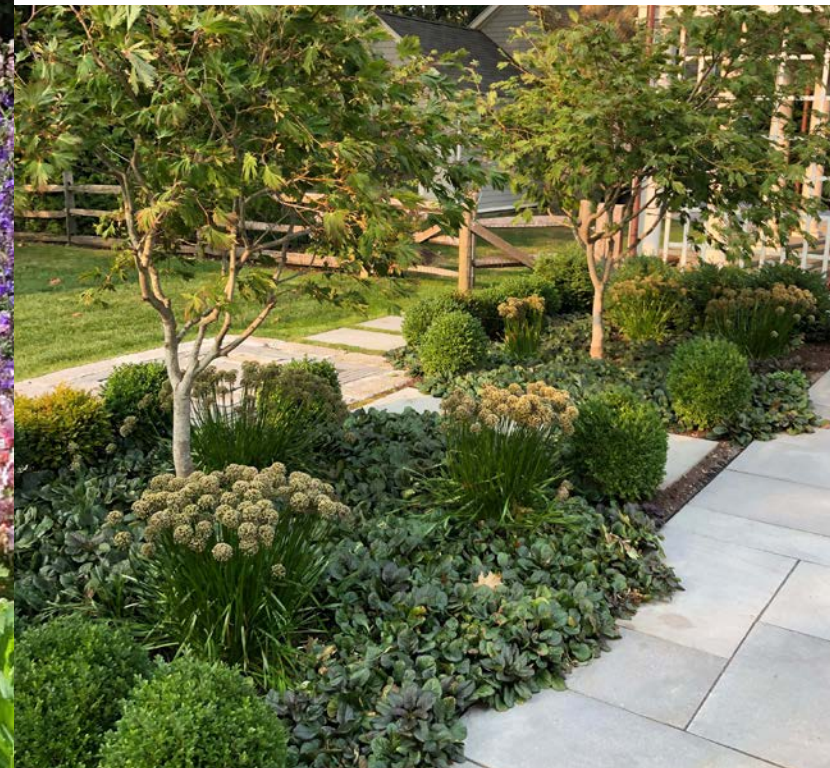
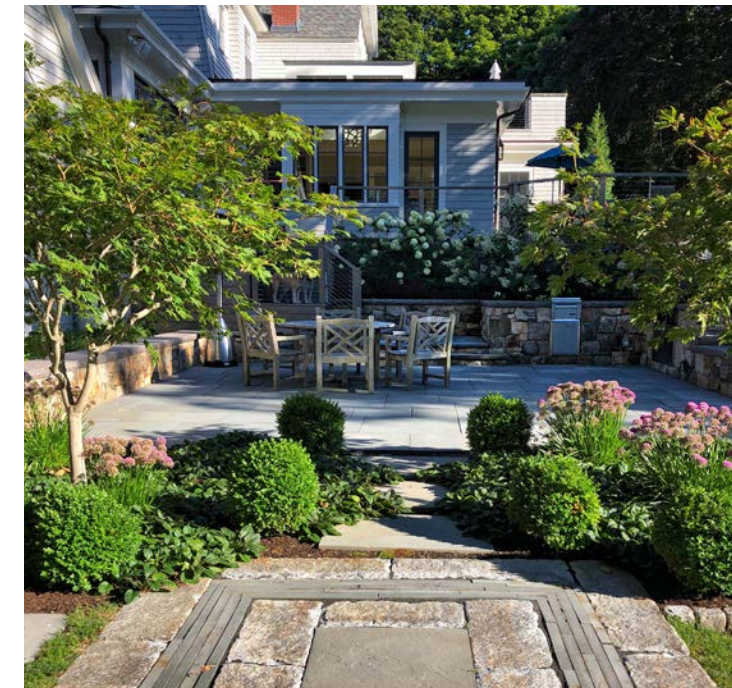

JUDGES' FEEDBACK:

Such a beautiful design on a potentially challenging site. I am most impressed with the location of the pool area. Looking at the plan initially I was taken aback by the location (in the front yard surrounded by a driveway), but when I saw the final design via the photos, I was shocked at how well this space tucked into the site. The gravel driveway and detailed pavers created a lovely entry into a very private garden room... and even though the drive is wrapped around three sides of the pool, the hedge and other plantings provide amazing privacy.



PHOTOGRAPH BY MICHEAL J LEE

gold award

HISTORIC CONCORD PROPERTY

Residential Category Over \$100,000

Project Location: Concord, Massachusetts

Zone: 6b

Hilarie Holdsworth Design LLC

Website: www.hilarieholdsworthdesign.com

Firm Location: Gloucester, Massachusetts

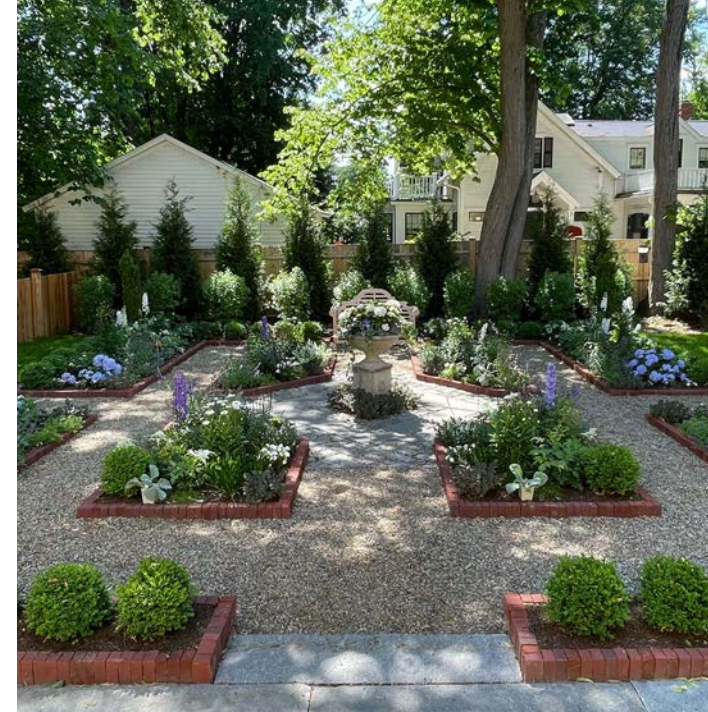

PHOTOGRAPH BY HILARIE HOLDSWORTH

JUDGES' FEEDBACK:

I love the combination of old and new in this design. The garden rooms are well-defined and have stunning materials. They flow beautifully from the house and to each other. The site lines and design principles are strong.



PHOTOGRAPH BY MICHEAL J LEE

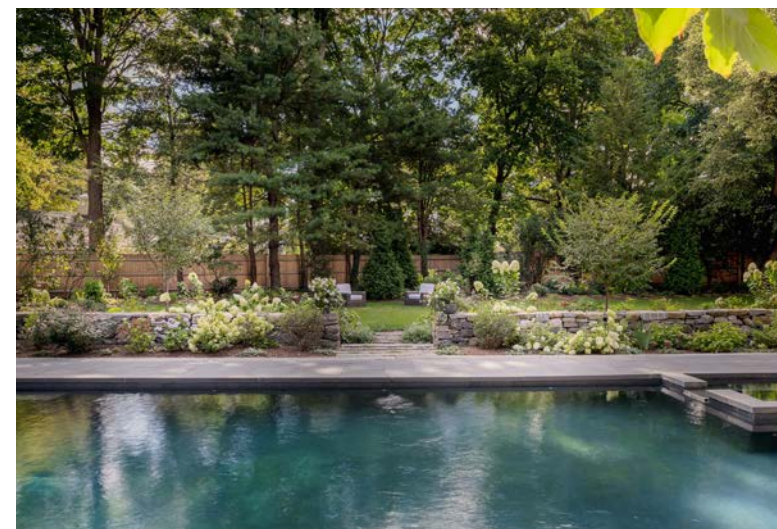

PHOTOGRAPH BY MICHEAL J LEE

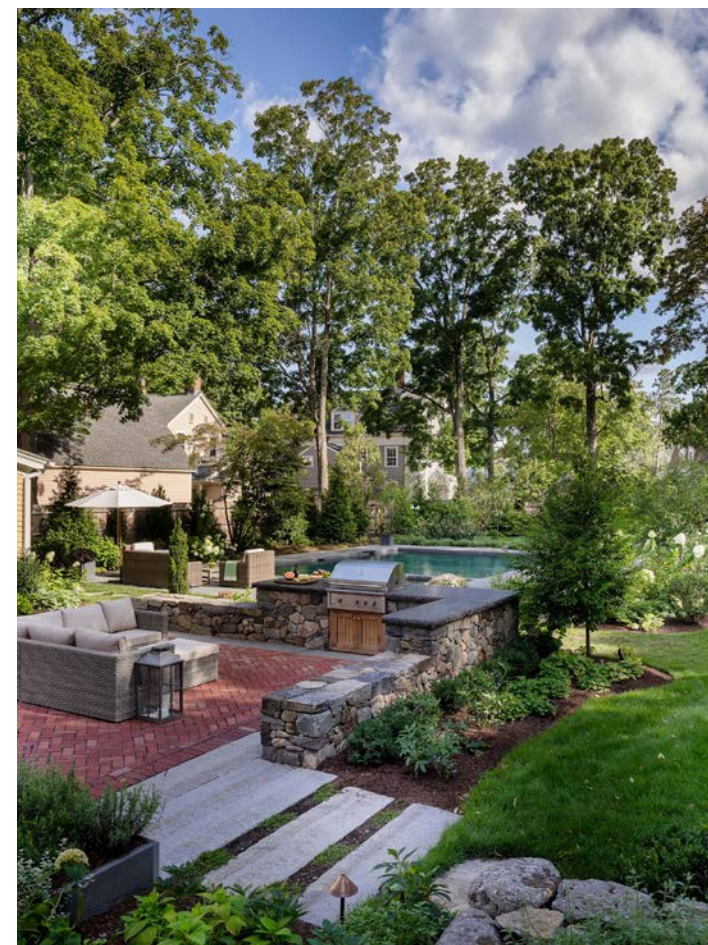

PHOTOGRAPH BY MICHEAL J LEE



PHOTOGRAPH BY MATTHEW CUNNINGHAM LANDSCAPE DESIGN LLC

JUDGES' FEEDBACK:

This design is stunning and impactful. The site is tucked into a steep hillside and surrounded by woodlands... and the design builds on that. The planting design, inspired by local plants, is a robust plant community that stabilizes the hillside while also adding a dynamic dimension. The hardscapes incorporate reclaimed stone and fit delicately into the site. Overall, this is a challenging, thoughtful, and beautiful design.



PHOTOGRAPH BY MATTHEW CUNNINGHAM LANDSCAPE DESIGN LLC

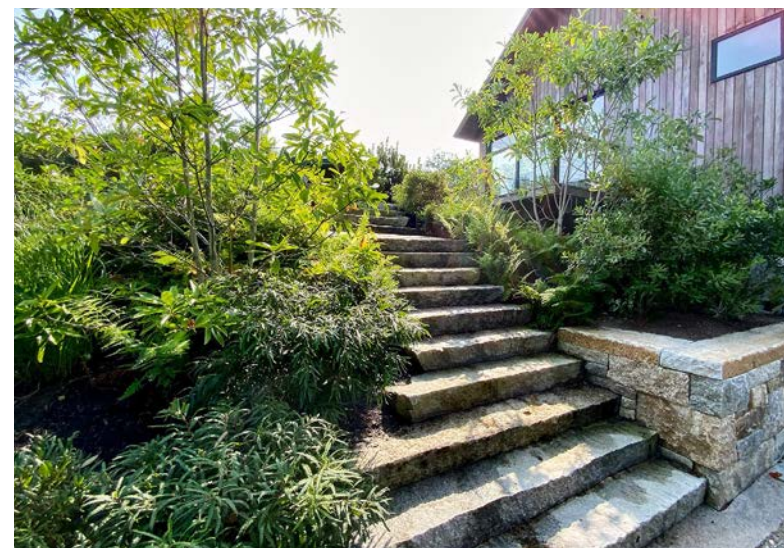

PHOTOGRAPH BY MATTHEW CUNNINGHAM LANDSCAPE DESIGN LLC



PHOTOGRAPH BY MICHAEL LEE

gold award

HUCKLEBERRY PERCH

Residential Category Over \$100,000

Project Location: Vineyard Haven, Massachusetts, Martha's Vineyard Zone: 7a

**Matthew Cunningham
Landscape Design LLC**

Website: www.matthew-cunningham.com

Firm Location: Stoneham, Massachusetts

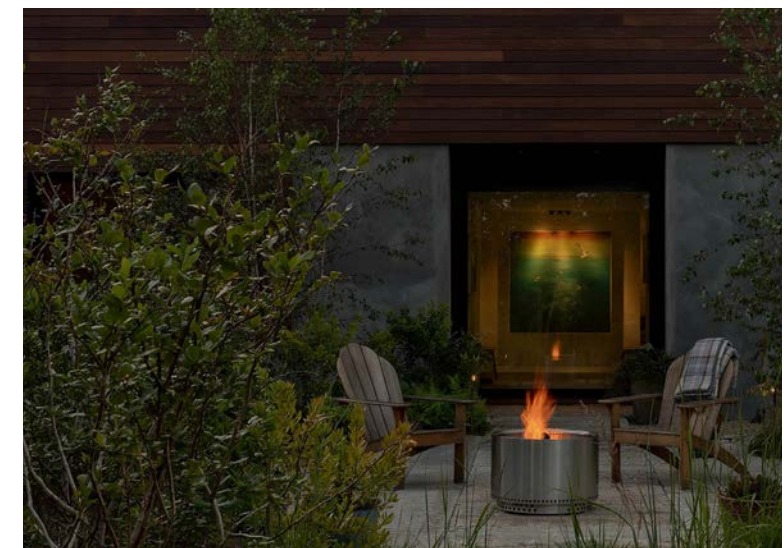

PHOTOGRAPH BY MICHAEL LEE



PHOTOGRAPH BY E.S. BAKER



PHOTOGRAPH BY MCLD

gold award

SEAL ROCK

Residential Category Over \$100,000
 Project Location: Scarborough, Maine
 Zone: 6a

Matthew Cunningham Landscape Design LLC

Website: www.matthew-cunningham.com
 Firm Location: Stoneham, Massachusetts



PHOTOGRAPH BY MCLD



PHOTOGRAPH BY MCLD

JUDGES' FEEDBACK:

The design is exceptionally well thought out. Attention to spatial relationships for planting areas, entertaining areas, and view preservation creates a unified and seamless layout; the diverse plantings complete the connection between all elements. It makes me want to stroll around the property and take in the views. Appropriate materials, including the reclaimed granite, honor the context of the surrounds and shows environmental consideration.

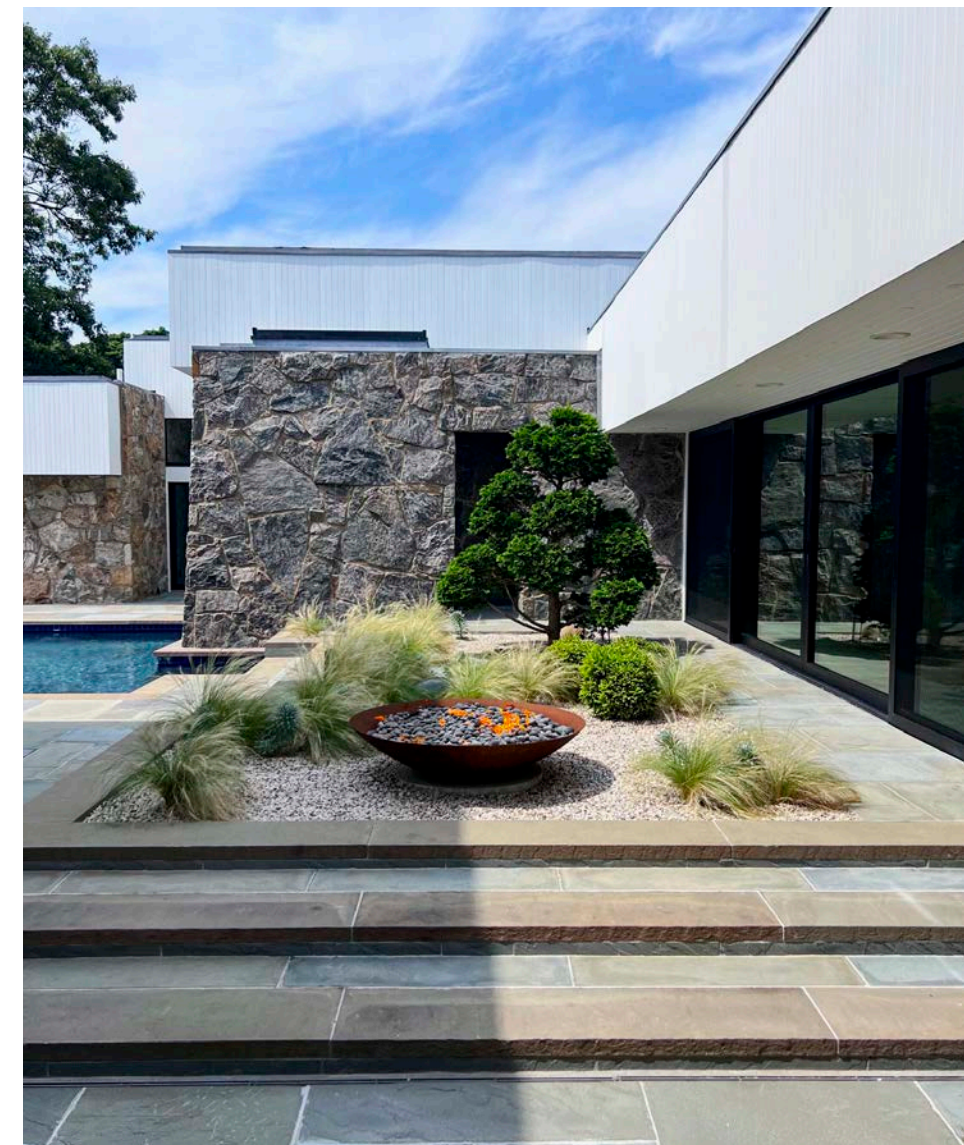

gold award

JUDGES' FEEDBACK:

This is an extraordinary transformation on so many levels. It's a unified space that encompasses so many elements with various functions, yet they all blend seamlessly. Attention to environmental responsibility with lawn reduction, native and diverse plant material, and particularly the beach restoration, speaks to the future of landscape design where accommodating human needs and environmental responsibility coexist.

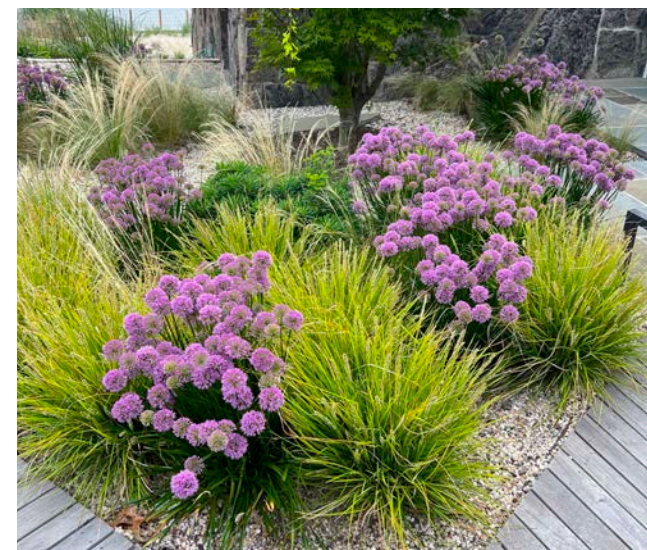

SEASCAPE REVIVAL: TRANSFORMING A MODERNIST 70S COASTAL GEM

Residential Category Over \$100,000

Project Location: Shelter Island, New York

Zone: 7a

Vickie Cardaro/ Buttercup Design Group

Website: www.buttercupdesigngroup.com

Firm Location: Shelter Island Heights, New York

PHOTOGRAPHS BY VICKIE CARDARO

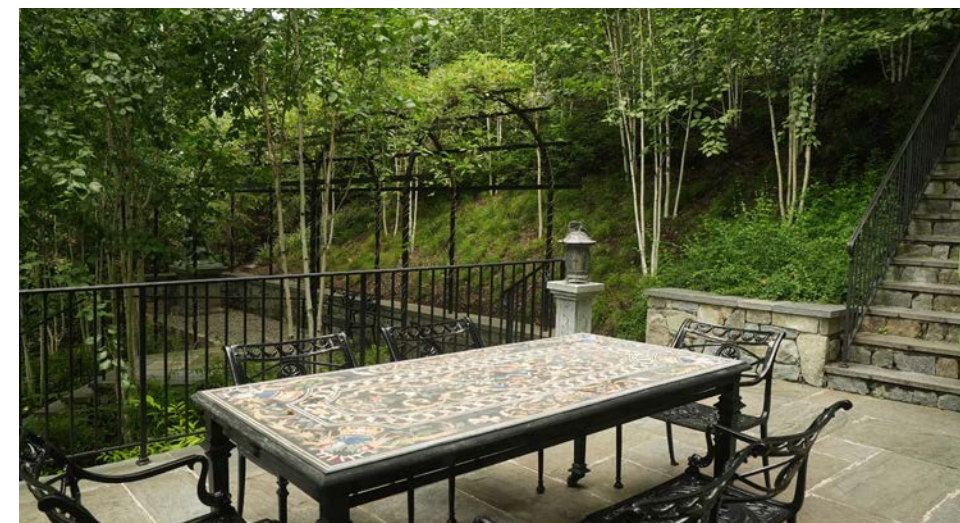
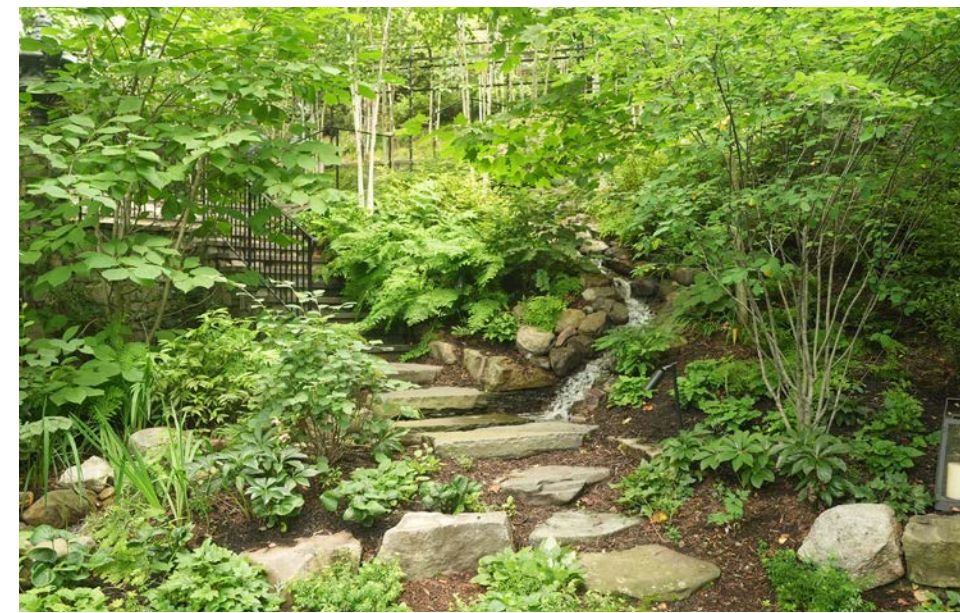

JUDGES' FEEDBACK:

This garden is a very creative solution to a challenging site! The execution of the stonework and layout of the central pathway is of high quality, and it does well to draw the visitor to explore deep into the property. I like the use of the ironwork throughout: it is functional and classic without extra ornamentation.



gold award

SEEKING RESPITE IN A RAVINE GARDEN

Residential Category Over \$100,000

Project Location: Washington, D.C.

Zone: 7a

**Garden Gate
Landscaping**

Website: www.gardengate.net

Firm Location: Silver Spring, Maryland



gold award

TAKOMA PARK PERCH
Residential Category Over \$100,000
Project Location: Silver Spring, Maryland
Zone: 7a/7b

Studio AKA

Website: www.studio-aka.com
Firm Location: Washington, D.C.

PHOTOGRAPHS BY ALLEN RUSS

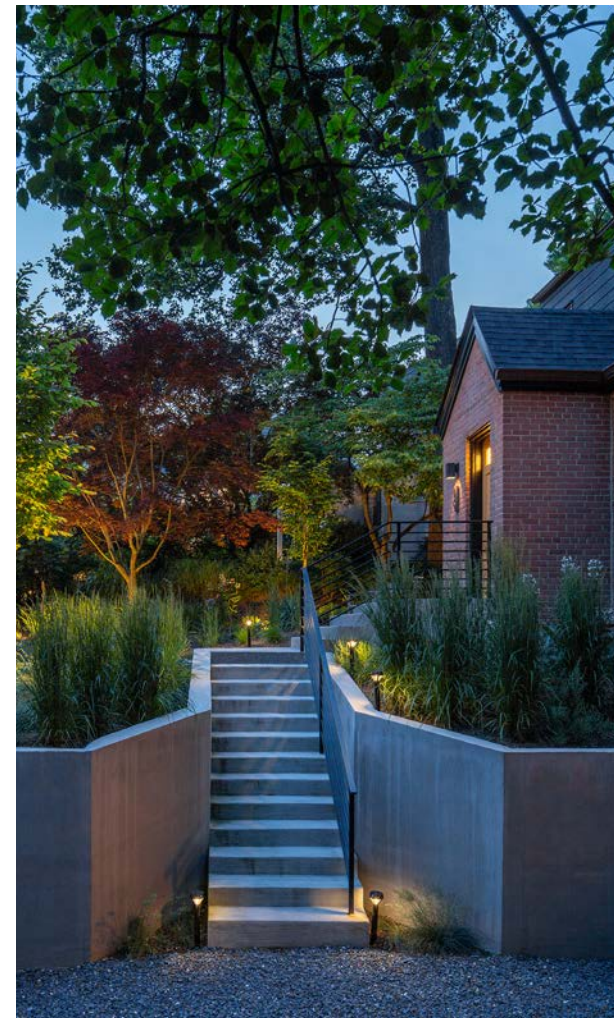
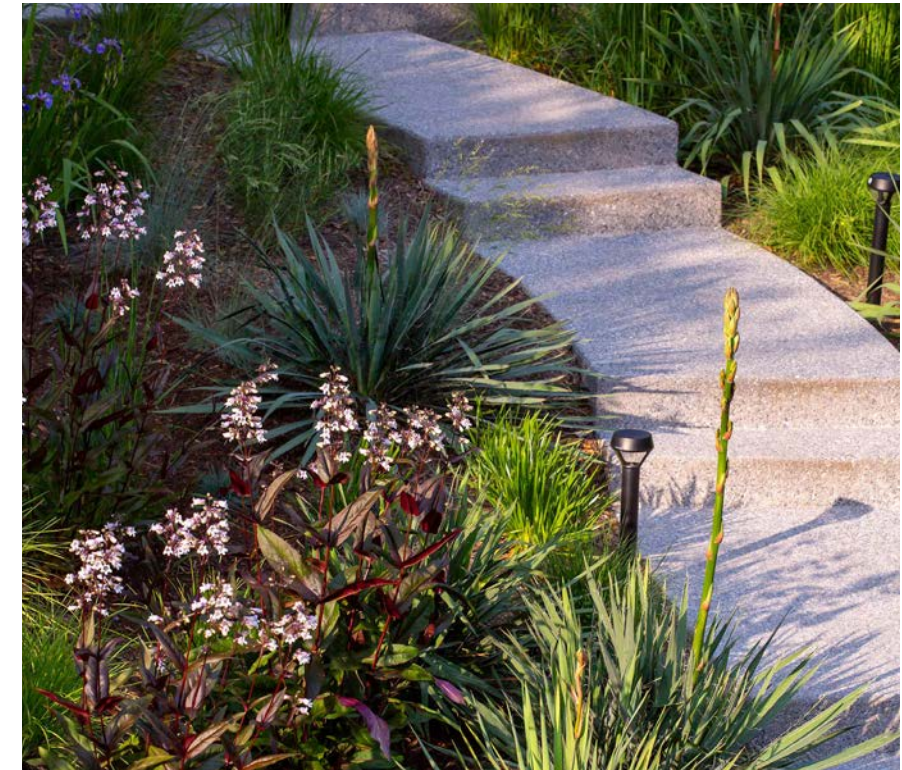

JUDGES' FEEDBACK:

This is a stunning transformation. Lowering the grades provides a full view of the house and garden. The ribbons of plantings move your eye through the garden and contrast nicely with the linear lines of the house. The slightly curved walkway provides a much-needed transition from the street, then onto the property and a walk through the garden, ending with a sense of arrival at the enlarged front stoop – with an inviting seating area. There is excellent spatial division and spatial awareness throughout the design; elements and spaces are well-scaled and balanced with the house. The plantings – diverse and ecologically responsible – complete the seamless connection between house and property.

gold award

THE MODERN CLASSICAL GARDEN

Residential Category Over \$100,000

Project Location: Oakland, California

Zone: 10a

Floradora Garden Design

Website: www.floradorgardens.com

Firm Location: Oakland, California

PHOTOGRAPHS BY BLAKE MARVIN PHOTOGRAPHY



JUDGES' FEEDBACK:

This garden adds function, beauty, and a sense of adventure to what was an unusable space. The plantings are lush and creative while still evoking a European classical garden. I love the nearly hidden spaces for reading, napping, and private conversation. The garden lends itself well to kids' play; and as the children grow, the garden will still work for them. I appreciate the use of native and pollinator-attracting plants as well as the preservation of native oaks and the Jacaranda.

gold award



THE WATER RUNS THROUGH

Residential Category Over \$100,000
Project Location: Philadelphia, Pennsylvania
Zone: 7a

Hess Landscape Architects

Website: www.hessla.com
Firm Location: Lansdale, Pennsylvania

PHOTOGRAPHS BY JEFF TOTARO



JUDGES' FEEDBACK:

This is a beautiful, stunning upgrade of a very challenging site. Maintaining the existing waterflow on the property and updating the drainage shows respect and concern for the environment. The well-designed garden and outdoor living spaces demonstrate excellent spatial awareness; the spaces are seamlessly woven together to achieve a sense of harmony and unity. The beautiful materials used honor the existing home and architecture.

silver award



BATHING POND AT THE EDGE OF THE FOREST
Residential Category Over \$100,000
Project Location: Solingen, Germany
Zone: 8b

Ingo Sperling, Exclusiv- Gestaltung

Website: www.garten-sperling.de
Firm Location: Solingen, Germany

PHOTOGRAPHS BY INGO SPERLING,
EXCLUSIV-GESTALTUNG



JUDGES' FEEDBACK:
A lovely, engaging design. The local materials are beautiful, and the natural pond and waterfall area are such a nice addition. The plantings work well with the space and I love that they are tucked into every nook and cranny.

silver award



BRICK ENDS FARM
Residential Category Over \$100,000
Project Location: South Hamilton, Massachusetts
Zone: 6b

Matthew Cunningham Landscape Design LLC

Website: www.matthew-cunningham.com
Firm Location: Stoneham, Massachusetts

PHOTOGRAPHS BY MATTHEW CUNNINGHAM
LANDSCAPE DESIGN LLC



JUDGES' FEEDBACK:
This is a grand collection of space detailed to include simple existing rustic elements with design details. The stone terrace transition into the lawn is a stellar example of this thoughtful design. A great overall design that ties the various site elements together into a garden.

silver award



CAPE COD RETREAT

Residential Category Over \$100,000
Project Location: Cape Cod, Massachusetts
Zone: 7a

**Thomas Mulcahy,
Mulcahy Design Group**

Website: mulcahydesigngroup.com
Firm Location: Norwood, Massachusetts

PHOTOGRAPHS BY GREG PREMUR



JUDGES' FEEDBACK:

Fantastic workmanship and wonderfully complete drawings. The outdoor shower and shower floor are marvelous, and the stonework is exquisite.



silver award

CASA COLIBRI

Residential Category Over \$100,000
Project Location: Burbank, California
Zone: 10b

**Laura Morton
Design**

Website: www.lauramortondesign.com
Firm Location: Los Angeles, California



PHOTOGRAPH BY ROSS WHITAKER



PHOTOGRAPH BY JEFF DUNAS



PHOTOGRAPH BY ROSS WHITAKER

JUDGES' FEEDBACK:

I love the eclectic style of this garden. The bright colors, patterns, and vintage furniture make it fun and inviting. The attention to detail in the stormwater capture, plant biodiversity, and the addition of native and pollinator plants is excellent.



PHOTOGRAPH BY JEFF DUNAS

silver award



ELEGANT GARDEN REJUVENATION

Residential Category Over \$100,000
Project Location: Bethesda, Maryland
Zone: 7b

Caroline Ervin Landscape Design LLC

Website: www.carolineervinlandscapedesign.com
Firm Location: Washington, D.C.



JUDGES' FEEDBACK:
The spaces for this project are well-defined and the selection of hardscape materials is beautiful.

silver award

ENCHANTED EVENING

Residential Category Over \$100,000
Project Location: Santa Fe, New Mexico
Zone: 6b

Mark G. Brotton, Principal Designer – Living Water Irrigation & Landscape, LLC

Website: www.livingwaterSF.com
Firm Location: Santa Fe, New Mexico

PHOTOGRAPHS BY DANIEL QUAT PHOTOGRAPHY



JUDGES' FEEDBACK:

What a lovely transformation of a difficult space! It's wonderful seeing how functional an outdoor room can be in such a narrow, linear area. I love that so many materials were re-purposed and locally sourced, plus water collection and drainage was given high priority. The lighting is a magical touch that allows the client to use this space for longer periods of time.



silver award



HOOVER HIDEOUT
Residential Category Over \$100,000
Project Location: Columbus, Ohio
Zone: 6a

Hidden Creek

Website: www.hiddencreeklandscaping.com
Firm Location: Hilliard, Ohio

PHOTOGRAPHS BY ASHTON ONASEKI
PRESTIGE PRO PHOTO



JUDGES' FEEDBACK:
I love how this formal design is tucked into the woodland. The garden rooms are well-defined and flow well between each other and the architecture. I especially love the paving in this design and how it changes and defines each living space.

silver award



INFINITE GETAWAY
Residential Category Over \$100,000
Project Location: Columbus, Ohio
Zone: 6a

Hidden Creek

Website: www.hiddencreeklandscaping.com
Firm Location: Hilliard, Ohio

PHOTOGRAPHS BY ASHTON ONASEKI
PRESTIGE PRO PHOTO



JUDGES' FEEDBACK:
This very thought-out and well-executed design allows for an easy transition between daytime family activities to luxurious evening entertainment. It truly does meet this definition and has lots of options for outdoor activity.



silver award

INSIDE OUT ON BROADWAY
Residential Category Over \$100,000
Project Location: Long Beach, California
Zone: 10b

Outer Spaces Exterior Design

Website: www.outer-spaces.com
Firm Location: Long Beach, California

PHOTOGRAPHS BY LAUREN AVILA PHOTOGRAPHY



JUDGES' FEEDBACK:
The hot tub area is marvelously updated and well-dated. The structure is strong, impressive, and creative in shape. It's a delightful space, particularly at night with the fire features.

silver award



MEADOW VIEW
Residential Category Over \$100,000
Project Location: Greenville, Delaware
Zone: 7a

Hess Landscape Architects

Website: www.hessla.com
Firm Location: Lansdale, Pennsylvania

PHOTOGRAPHS BY CHARLES HESS



JUDGES' FEEDBACK:
A well-defined and anchored landscape that merges the architecture with the site. Established and solid, this is a great transition to meadow areas.

silver award



NATIVE JEWEL
Residential Category Over \$100,000
Project Location: Santa Fe, New Mexico
Zone: 6b

Mark G. Brotton, Principal Designer – Living Water Irrigation & Landscape, LLC

Website: www.livingwaterSF.com
Firm Location: Santa Fe, New Mexico

PHOTOGRAPHS BY MARK G. BROTTON



JUDGES' FEEDBACK:
A large, commanding site with a view. The details are around the house with functional and attractive swales and native plantings. A great job on construction and design.

silver award

PLEASANTON PARADISE
Residential Category Over \$100,000
Project Location: Pleasanton, California
Zone: 9b

Susan Friedman Landscape Architecture

Website: www.susanfriedmanlandscape.com
Firm Location: San Ramon, California

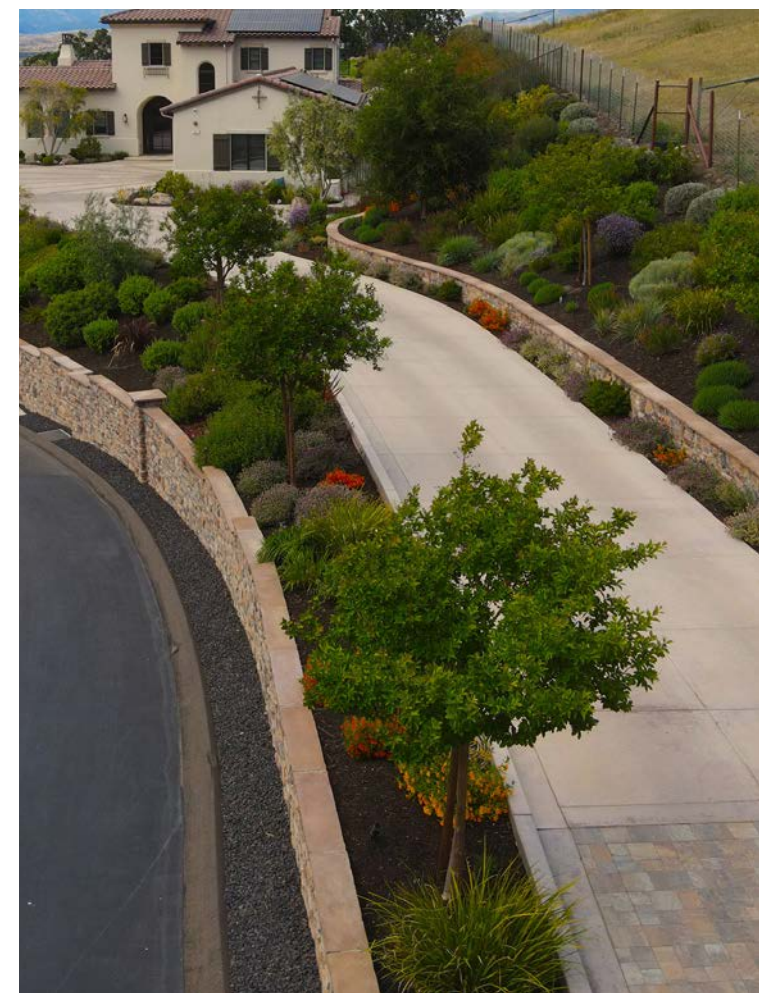
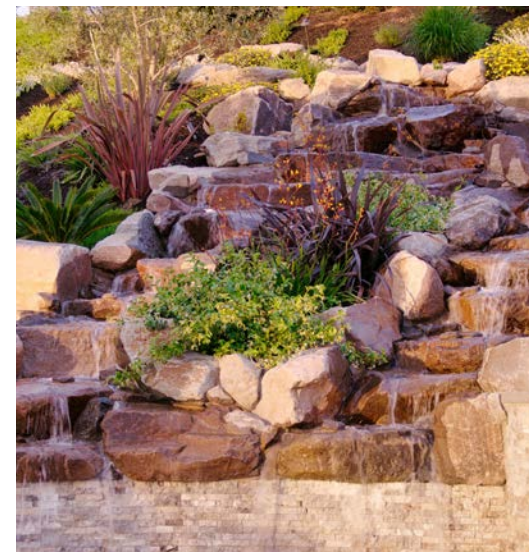

JUDGES' FEEDBACK:
I love the concept of an adult playground... and this design certainly achieves that!

silver award



PHOTOGRAPH BY DAVE MALECKI

RETIREMENT PLAN

Residential Category Over \$100,000
Project Location: Long Grove, Illinois
Zone: 5

Larry Carnes/ Reflections Water Gardens

Website: www.reflectionswatergardens.com
Firm Location: West Dundee, Illinois



PHOTOGRAPH BY DAVE MALECKI PHOTOGRAPHY



PHOTOGRAPH BY DAVE MALECKI PHOTOGRAPHY

JUDGES' FEEDBACK:

This project has a beautiful balance of technical, environmental, and aesthetic details. I love that this pond is both a pool and wildlife habitat.



PHOTOGRAPH BY JILL BUCKNER PHOTO

silver award



PHOTOGRAPH BY HAWK VISUALS

SEASIDE RETREAT

Residential Category Over \$100,000
Project Location: Duxbury, Massachusetts
Zone: 7a

Jim Douthit, Colin Hand, Kate Notman

Website: abladeofgrass.com
Firm Location: Sudbury, Massachusetts



PHOTOGRAPH BY JIM DOUTHIT

JUDGES' FEEDBACK:

The entry to the property and approach to the house provides a wonderful sense of arrival. The beautiful bluestone entry patios are welcoming and make a nice connection between the house and the property.



PHOTOGRAPH BY TAYLOR AHEARN

The entertaining spaces in the back are nicely scaled and arranged such that views remain intact – just like the client requested.

I especially like the very nice treatment of the pool at the sloped end of the property, giving it a vanishing look. It makes me want to walk to the edge and see what's there.



PHOTOGRAPH BY TAYLOR AHEARN

silver award



STOLL HILL RESIDENCE
Residential Category Over \$100,000
Project Location: Louisville, Kentucky
Zone: 7a

Myers + Co. Landscape Architecture

Website: www.myersandcompanyla.com
Firm Location: Louisville, Kentucky

PHOTOGRAPHS BY TIM FURLONG JR.

silver award



WALLACE OASIS
Residential Category Over \$100,000
Project Location: Santa Rosa, California
Zone: 9

Olga Stritar

Website: artisticgardendesigns.com
Firm Location: Foster City, California

PHOTOGRAPHS BY LUXURY HOME BUILDER:
PROVIDENCIA HOMES



JUDGES' FEEDBACK:
Well-proportioned elements in the back are laid out on a strong axis with good connections and flow among them. The concrete provides a very modern feel that works well with the linear lines.

The planting plan will be stunning when it fills in – wonderful layering, colors, and textures. Excellent consideration of site conditions and environmental concerns; and the minimal lawn is appreciated.



This is a stunning transformation that connects the house and garden to the view and provides family and entertaining spaces while respecting the environment.



JUDGES' FEEDBACK:

The garden is now as grand as the home. Well done. I appreciate the diamond repetitions from the existing patio to the pool surround. The new space opens out to the rest of the property and allows the homeowners to really enjoy the view beyond. The grade change is a big challenge, and the design solution makes good use of it. The plant bed on the East side of the pool blurs the line between cultivated space and the woods beyond in a successful way.

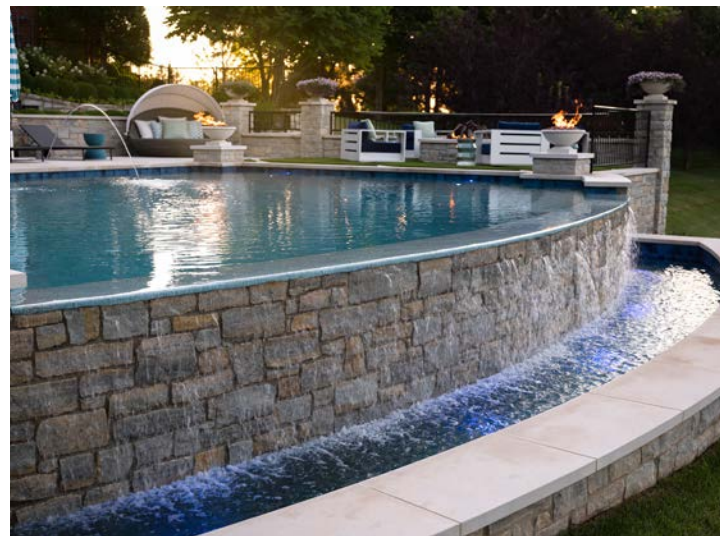
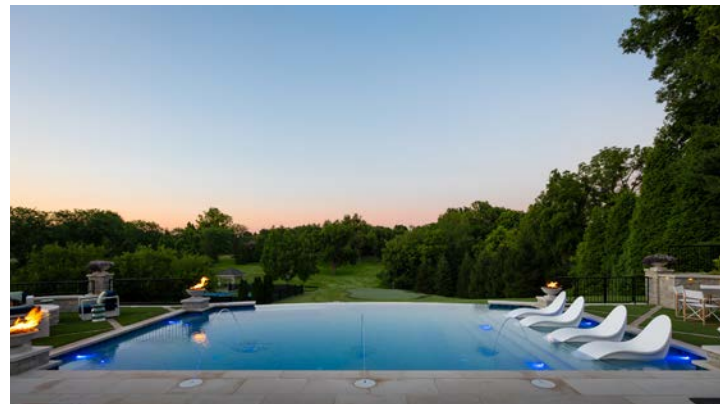

silver award

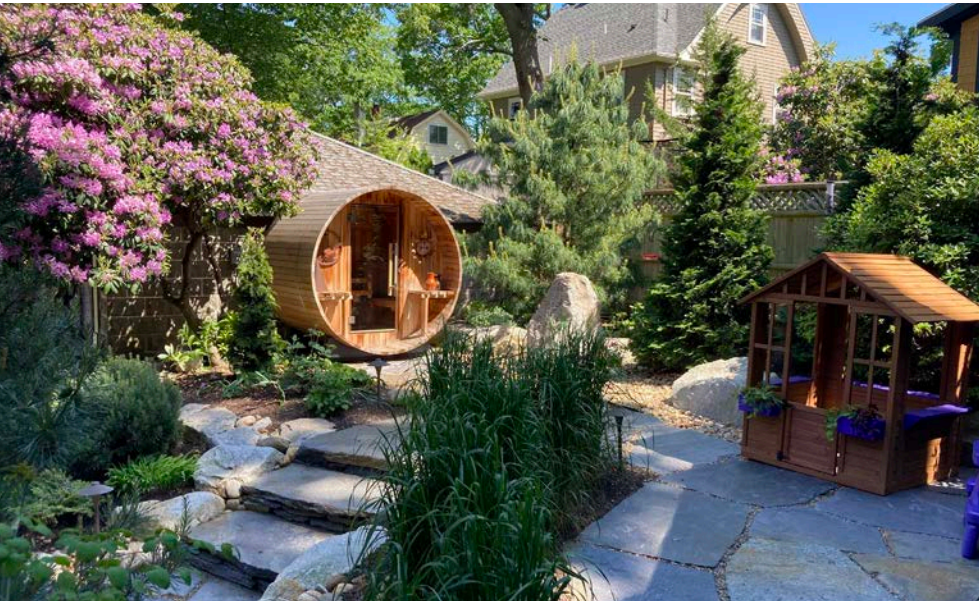

PHOTOGRAPH BY PARKER GARDEN DESIGN

ZEN OASIS

Residential Category Over \$100,000
Project Location: Melrose, Massachusetts
Zone: 6b

Bill Parker & Parker Garden Design

Website: www.parkergarden.com
Firm Location: Nashua, New Hampshire

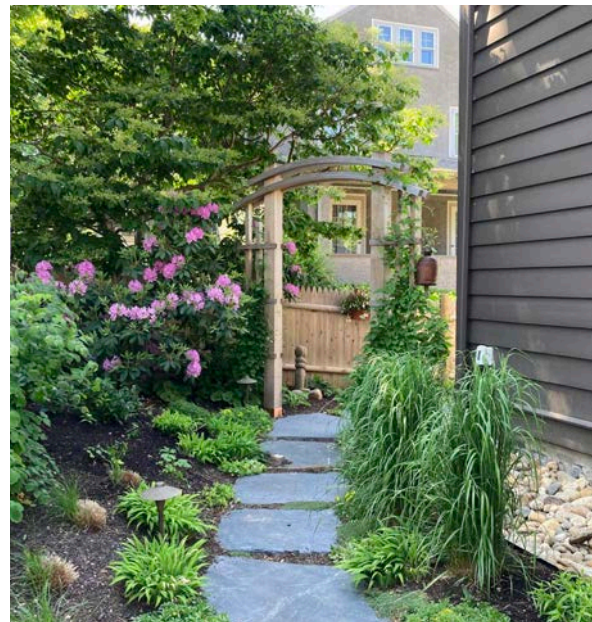

PHOTOGRAPH BY PARKER GARDEN DESIGN



PHOTOGRAPH BY RICH VALLEY

JUDGES' FEEDBACK:

This is a gorgeous transformation. Very nice use of Zen elements, plant materials, and touches to create a harmonious, unified space. The Zen style pavers flow around the garden and create nicely proportioned spaces with good spatial division. The textured and layered plantings are a balanced combination of seasonal interest and foundation plants that anchor the garden through winter.

The shelter offers a sought-after relaxing destination with its cozy surrounds and views of the garden; it's tucked away and blends seamlessly. The change in elevation and the pine tree make a welcoming entry to the space.

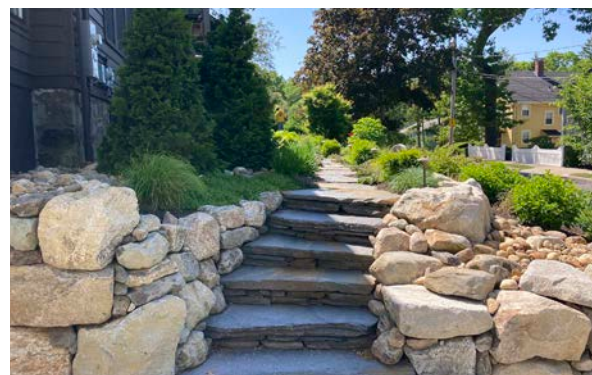

PHOTOGRAPH BY PARKER GARDEN DESIGN

bronze award



AUKER PROJECT

Residential Category Over \$100,000
Project Location: San Diego, California
Zone: 10b

Joel Berlin for AnandaScapes LLC

Website: www.AnandaScapes.com
Firm Location: San Diego, California

PHOTOGRAPHS BY PREVIEW FIRST



JUDGES' FEEDBACK:

A solid design for a difficult site. The spaces are well defined and flow easily from one room to another. The fireplace tucked into the retaining wall is a fascinating addition to this project.

bronze award



PIEDRAS CT. RESIDENCE
Residential Category Over \$100,000
Project Location: Alamo, California
Zone: 9b

Zacate Landscape Design

Website: www.zacld.com
Firm Location: San Francisco, California

PHOTOGRAPHS BY MARIO HERRADA



JUDGES' FEEDBACK:

"The design intent was to create a sophisticated environment that would be suitable for entertaining business clients but also be user friendly so that children would feel at home as well." This intent has been well met. I love the covers with the shared posts and the well-appointed outdoor cooking area. The level transitions are well defined. The overall plan is very cohesive and invokes interaction.



bronze award



SAILOR'S RETREAT | A CITY ESCAPE

Residential Category Over \$100,000
Project Location: Wilmington, Delaware
Zone: 7

GreenRoots Landscaping

Website: www.greenrootslandscaping.com
Firm Location: Kennett Square, Pennsylvania

PHOTOGRAPHS BY RUTT CREATIVE

JUDGES' FEEDBACK:

I love the feel and layout of this design. It fits perfectly into the small site, and the garden rooms are beautifully designed; plus, the material choices provide stunning unity. I love how the fire pit area was tucked in to utilize more space.

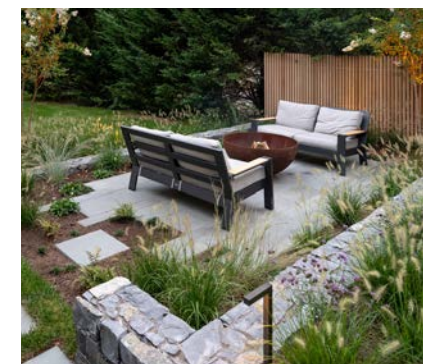

SAVE TIME IN EVERY PHASE OF DESIGN

Vectorworks Landmark 2025 opens a whole new world of visual understanding. It's the industry-leading solution for integrated 2D/3D landscape design, now with a new 3D Curb tool, Survey Point tool, and features that help you design with sustainability in mind.

Try it for free: [VECTORWORKS.NET/LANDMARK25](https://vectorworks.net/landmark25)

VECTORWORKS

Labels in the image include: Biodiversity Net Gain (Urban) Rain Garden, Biomass Density Index: Shrubs - 3, Permeability Rate: 13.2 mm/hr, Solar Reflectance Index: 41, Permeability Rate: 14,475 mm/hr, Urban Greening Factor: Permeable Paving - 0.1, Sustainable Urban Drainage Feature, Biodiversity Net Gain (Urban): Rain Garden (and other vegetated sustainable drainage elements) - 0.7

2024 award winners

Planting Design

Our vibrant community of landscape design professionals and enthusiasts are at the heart of everything we do!

Join Us at apld.org

visit the website at www.apld.org

gold award



GARDEN OF RESILIENCE: A WATERWISE HAVEN THAT NEVER RESTS

Planting Design Category
Project Location: Los Altos, California
Zone: 9b

Shireen Zia, CPLD, EcoGardens Landscape Design

Website: www.ecogardens.design
Firm Location: Los Altos, California

PHOTOGRAPHS BY SHIREEN ZIA

JUDGES' FEEDBACK:

It's great to see more clients embracing a reduced water need landscape. Great seasonality of plants and I like the seating nook for reading and enjoying the garden. Adding some topography changes was a great idea.



gold award

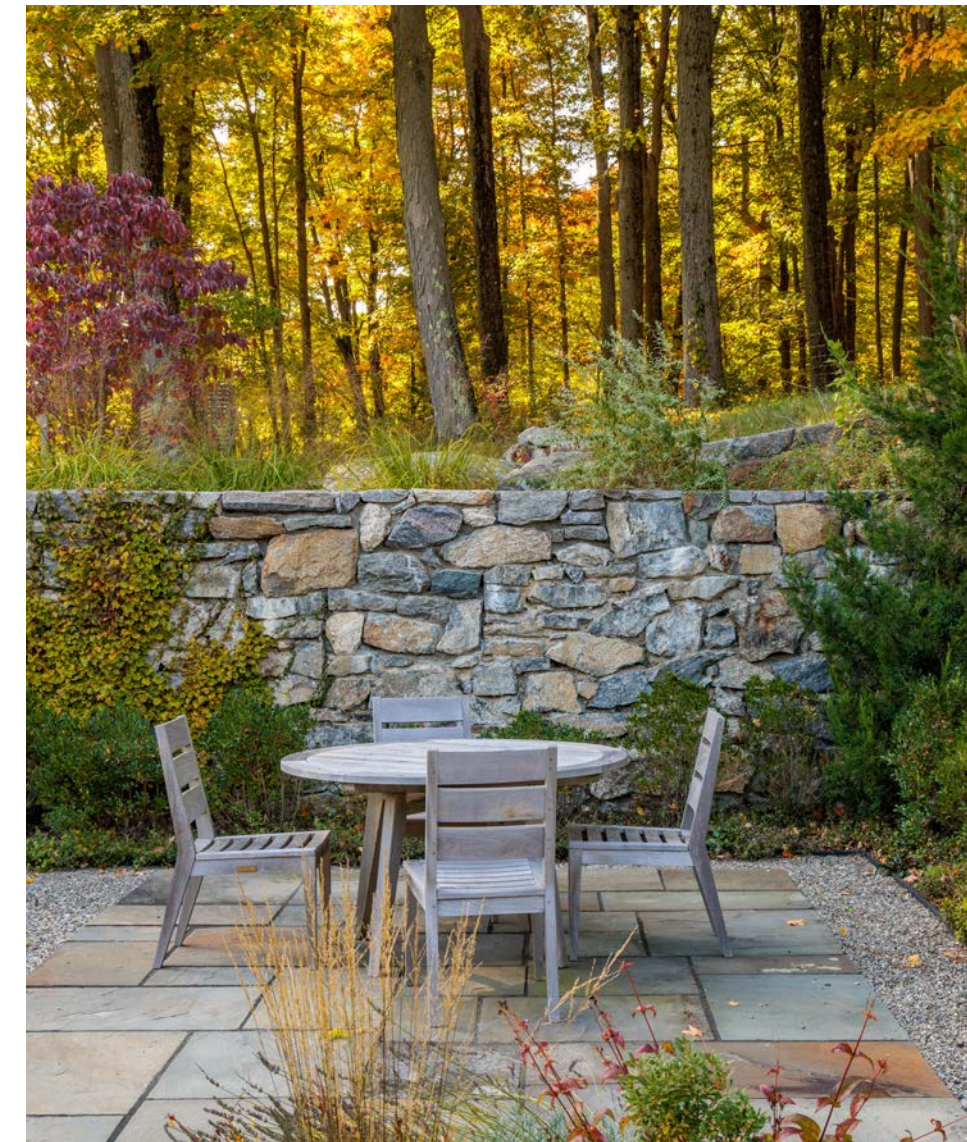

JUDGES' FEEDBACK:

This design is all about evolving from the place... and it's done beautifully. The final shapes are inspired not only by the surrounding landscape but also culturally, from the previous architecture... both in form and material. Sensitivity to the environment is infused throughout the design. Stunning.

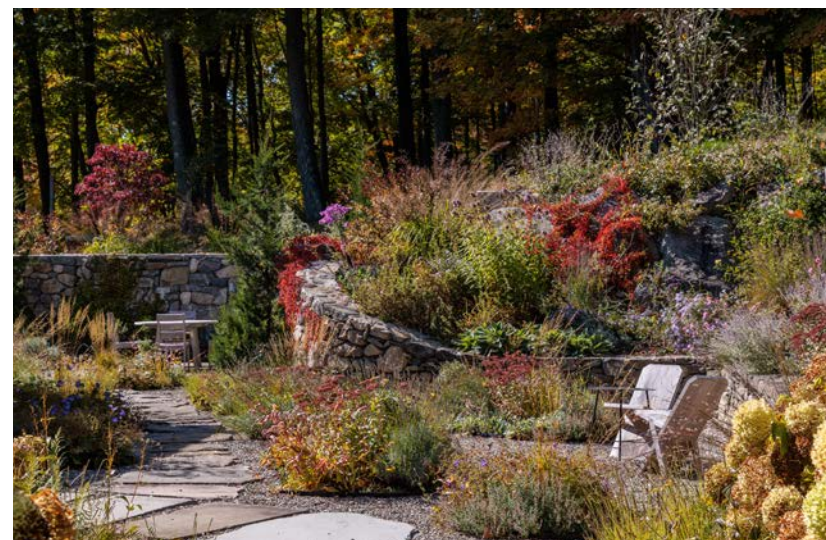

LAKEFRONT IDYLL

Planting Design Category
Project Location: Carmel, New York
Zone: 6b

Hortulus Animae

Website: www.hortulusanimae.com
Firm Location: Catskill, New York

PHOTOGRAPHS BY ALON KOPPEL

silver award

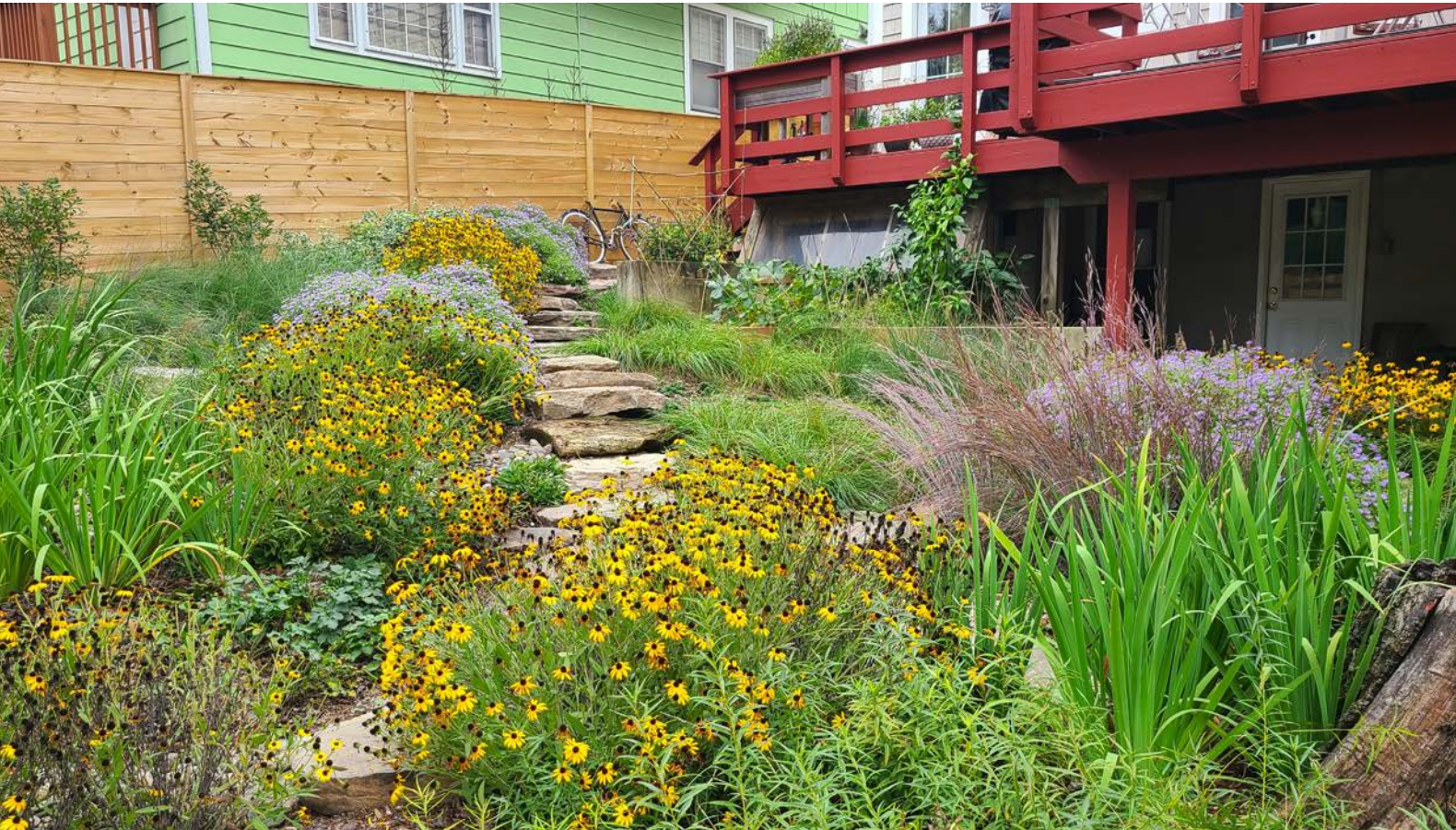

BACKYARD NATIVE HABITAT

Planting Design Category
Project Location: Takoma Park, Maryland
Zone: 7b

Kellie Cox & Strawberry Fields LLC

Website: www.strawberrygardendesign.com
Firm Location: Silver Spring, Maryland

PHOTOGRAPHS BY KELLIE COX



JUDGES' FEEDBACK:

Texture, movement, color and repetition transformed the space from a lifeless backyard suburbia to one that is vibrant and alive.

silver award

GREENWICH STREETSCAPES

Planting Design Category
Project Location: Greenwich, Connecticut
Zone: 6a

Mark A Greenwald, FAPLD/ Carrie M Greenwald, FAPLD - Maher & Greenwald Fine Gardens

Website: www.mahergreenwaldgardens.com
Firm Location: Stamford, Connecticut



PHOTOGRAPH BY THA



PHOTOGRAPH BY PUT



PHOTOGRAPH BY PUT



PHOTOGRAPH BY THA

JUDGES' FEEDBACK:

Welcoming plantings provide color, texture, and movement for residents to enjoy. This is a sophisticated blend of materials and colors.

silver award

2024 award winner

Non-Residential Under \$100,000



STERILE TO SLEEK

Non-Residential Under \$100,000
Project Location: Frankfort, Kentucky
Zone: 6b

Inside Out Landscape Design

Website:
www.kentuckylandscapedesign.com
Firm Location:
Frankfort, Kentucky

PHOTOGRAPHS BY ANDREA WILSON MUELLER



JUDGES' FEEDBACK:

This design is a creative re-envisioning of the space. Design elements and plantings create a welcoming environment for the building entrance. The siting of elements and plant selection allow for an open view to both the interior space as well as from the interior.



silver award

2024 award winner

Non-Residential \$100,000 – \$500,000



EAGLE RARE

Non-Residential \$100,000 – \$500,000
Project Location: Frankfort, Kentucky
Zone: 6b

Inside Out Landscape Design

Website:
www.kentuckylandscapedesign.com
Firm Location:
Frankfort, Kentucky

PHOTOGRAPHS BY ANDREA WILSON MUELLER



JUDGES' FEEDBACK:

The plant selection is stunning. Layers of textures meet the client's need to obscure the building and create directional flow, while adding a sense of depth in a confined space. Seeing the trees in place and supporting each other in a sophisticated fashion is quite something. Add to that the plants acting as living mulch is a win-win.



silver award



**GREENWICH CLOSE:
POCKET PARK**
Non-Residential \$100,000 – \$500,000
Project Location: Greenwich, Connecticut
Zone: 6-6a

**Carrie Maher
Greenwald,
Maher &
Greenwald Fine
Gardens**

Website: www.mahergreenwaldgardens.com
Firm Location: Stamford, Connecticut



JUDGES' FEEDBACK:
This design is a thoughtful approach to transforming a space into beautiful and usable areas for the residents of the complex. The sweeping entry curve invites you in, leading to areas to stroll and to sit and contemplate. The plant life is a welcome distraction from the bustle of a downtown area, and the continuing transformation of texture and colors has something for everyone. Overall, a wonderful transformation from a dreary, unwelcoming site to one that is bursting with life.



2024 award winner
**Non-Residential
Over \$500,000**





gold award

HAMPSHIRE TEMPLE
Non-Residential Over \$500,000
Project Location: Hampshire, UK
Zone: 8b

McWilliam Studio

Website: www.mcwilliamstudio.com
Firm Location: Old Amersham, Buckinghamshire, UK

PHOTOGRAPHS BY ALISTER THORPE



JUDGES' FEEDBACK:

The expanse of the property provides the opportunity for a vast and expressive plant palette that brings a fresh experience. The site plan is cohesive and structured, allowing for the plantings to soften the geometry of the site. The design transforms the site into a vibrant landscape that I want to explore.





PHOTOGRAPH BY DOES MEDIA

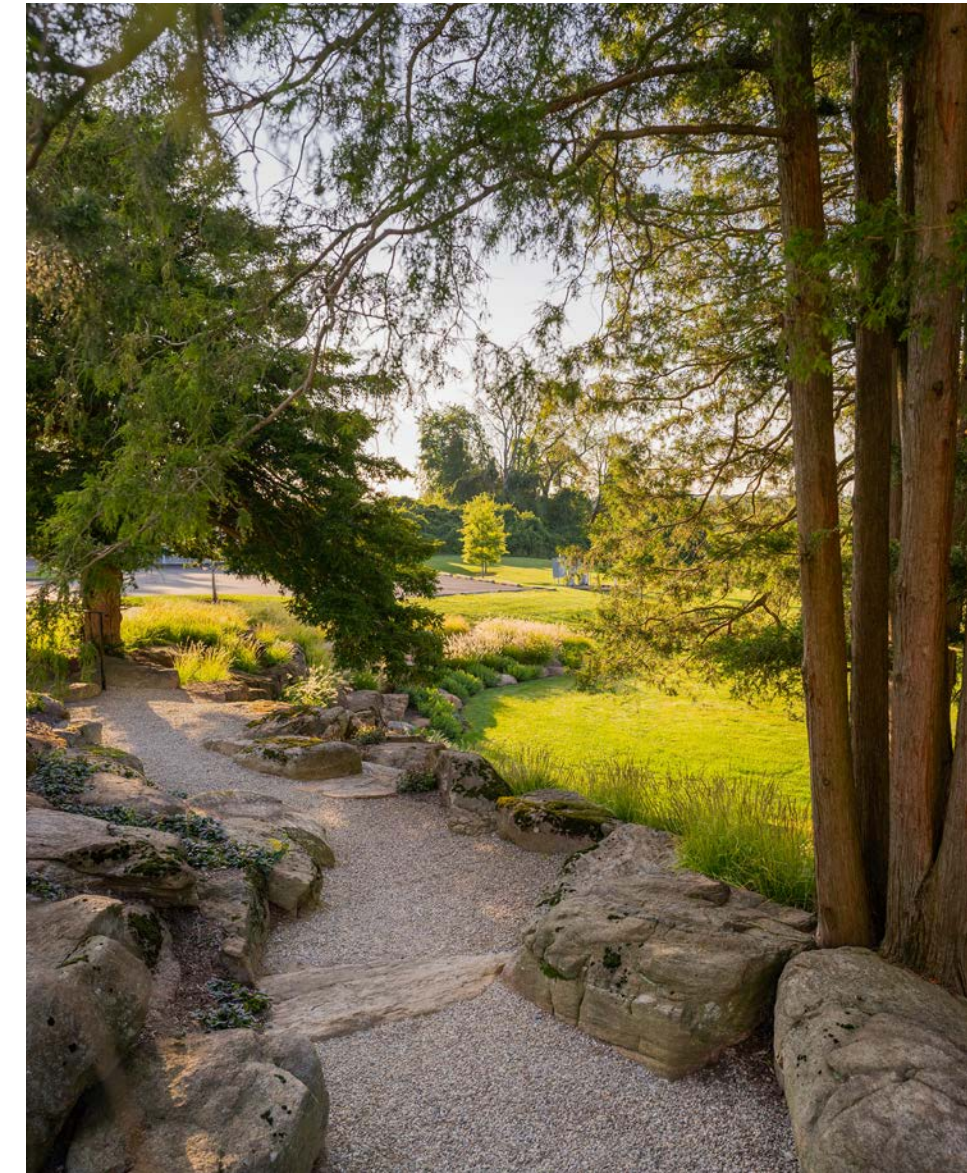

PHOTOGRAPH BY DOES MEDIA

JUDGES' FEEDBACK:

A masterful juxtaposition of old and new, honoring the site and breathing new life into and around a historic structure. A fully realized design brief blending the needs of the client with the needs of the public, and a win from an aesthetic and environmental perspective.



PHOTOGRAPH BY DOES MEDIA



PHOTOGRAPH BY DANILO MAFFEI

LOMAN HALL HISTORIC ADAPTATION

Non-Residential Over \$500,000

Project Location: Malvern, Pennsylvania

Zone: 7a

Danilo Maffei, CPLD, FAPLD

Website: www.danilomaffei.com

Firm Location: Kennett Square, Pennsylvania

DID YOU KNOW

NOT-SO-FUN FACTS ABOUT PLASTIC HORTICULTURAL POTS



SCAN ME

HEALTHY POTS, HEALTHY PLANET WANTS TO HELP BY...

- Supporting production of recycled pots
- Encouraging manufacturers to develop alternative, sustainable containers
- Increase demand for alternatives by inviting the community to make commitments

JOIN OUR COALITION TODAY!



WEBSITE: HealthyPotsHealthyPlanet.org

INSTAGRAM: @healthypotshealthyplanet @landscapedesigners

2024 award winners

Show Gardens



gold award

HORATIO'S GARDEN CHELSEA 2023

Show Gardens Category
Project Location: London, UK
Zone: 9a

Harris Bugg Studio

Website: www.harrisbugg.com
Firm Location: London, UK



PHOTOGRAPH BY MARIANNE MAJERUS



PHOTOGRAPH BY MARIANNE MAJERUS



PHOTOGRAPH BY LUCY SHERGOLD

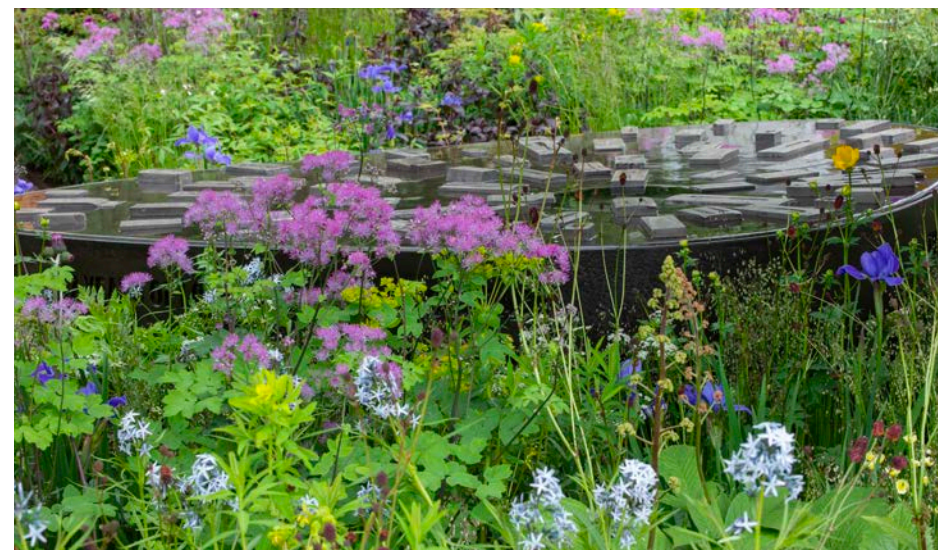

PHOTOGRAPH BY MARIANNE MAJERUS

JUDGES' FEEDBACK:
Wow! How beautiful. Imagine recuperating in a hospital, being confined to a bed or having access with a wheelchair and exploring this space. Living, breathing, transforming a situation from cold and sterile to one bursting with life makes it an experience, and a positive affirmation for healing.

gold award

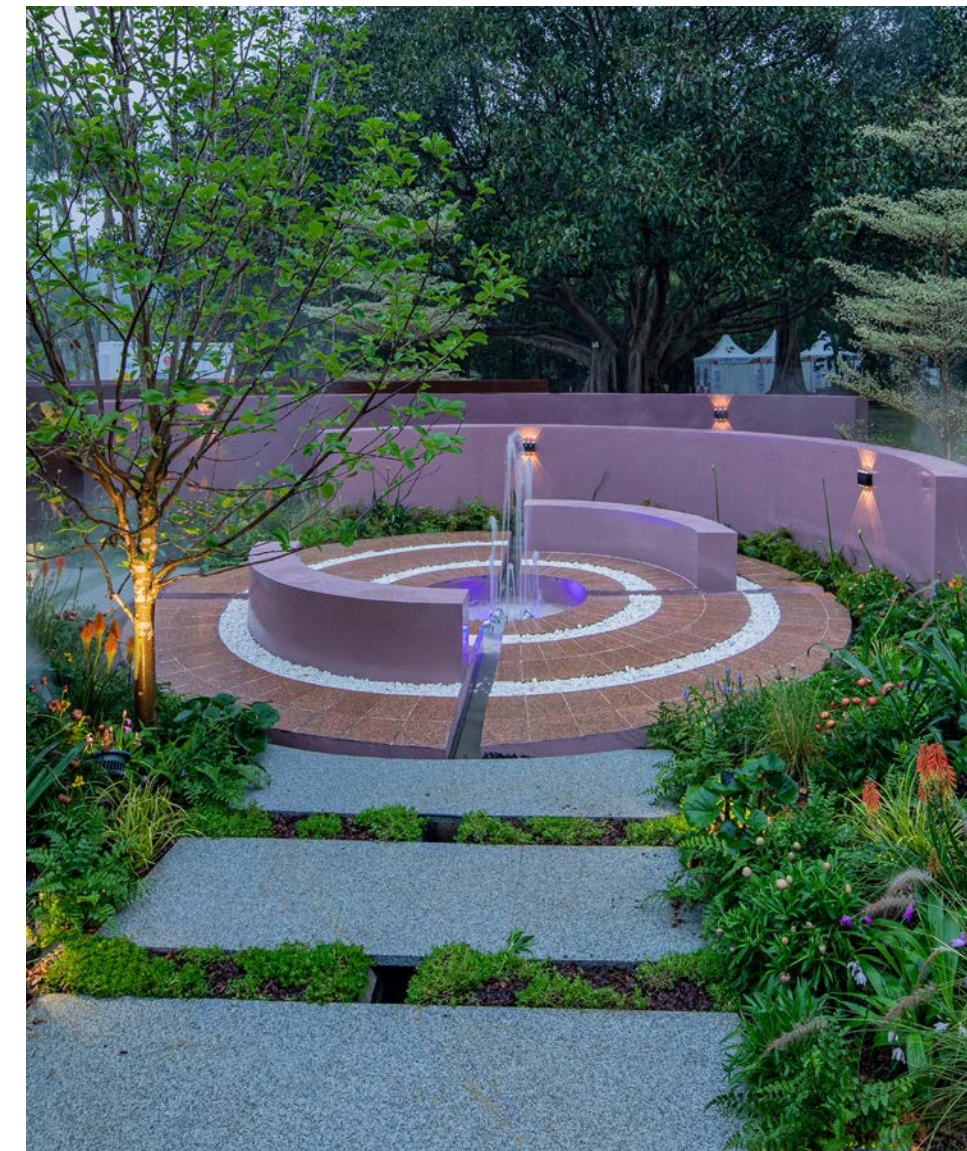

JUDGES' FEEDBACK:

A beautiful cohesive garden, from hardscape to planting. The design invites one in and allows you to slow down. A thoughtful approach to create a contemplative space in a bustling city environment. The plantings complement the curved walls, and the walls showcase the plantings. This garden is wonderfully conceived!



ROUNDBABOUT

Show Gardens Category
Project Location: Shenzhen, China
Zone: 11b

Susan Cohan Gardens

Website: www.susancohangardens.com
Firm Location: Boonton, New Jersey

PHOTOGRAPHS BY SUSAN COHAN

gold award

TRANSCENDENCE GARDEN

Show Gardens Category

Project Location: Chelsea, London, UK

Zone: 9

Gavin McWilliam and Andrew Wilson

Website: www.mcwilliamstudio.com

Firm Location: Old Amersham, Buckinghamshire, UK



PHOTOGRAPH BY CHARLIE HOPKINSON



PHOTOGRAPH BY JOANNA KOSSAK



PHOTOGRAPH BY JOANNA KOSSAK



PHOTOGRAPH BY JOANNA KOSSAK

JUDGES' FEEDBACK:

An evocative space – serene and contemplative. I can imagine entering the space and being comforted and soothed, allowing you to experience loss, grief and coming away lighter in spirit.

silver award



**CREATE, EAT, SLEEP:
A GARDEN RETREAT**
Show Gardens Category
Project Location: Seattle, Washington
Zone: 8

GardenGirls, LLC

Website: www.gardengirl.com
Firm Location: Snohomish, Washington

PHOTOGRAPHS BY GARDENGIRLS, LLC



JUDGES' FEEDBACK:
An interesting overall concept for a garden space! Each area had spatial definition, and I liked the use of the planters to create the edges of the garden area.

2024 award winners Small Gardens



gold award



PHOTOGRAPH BY DAN HUNTER

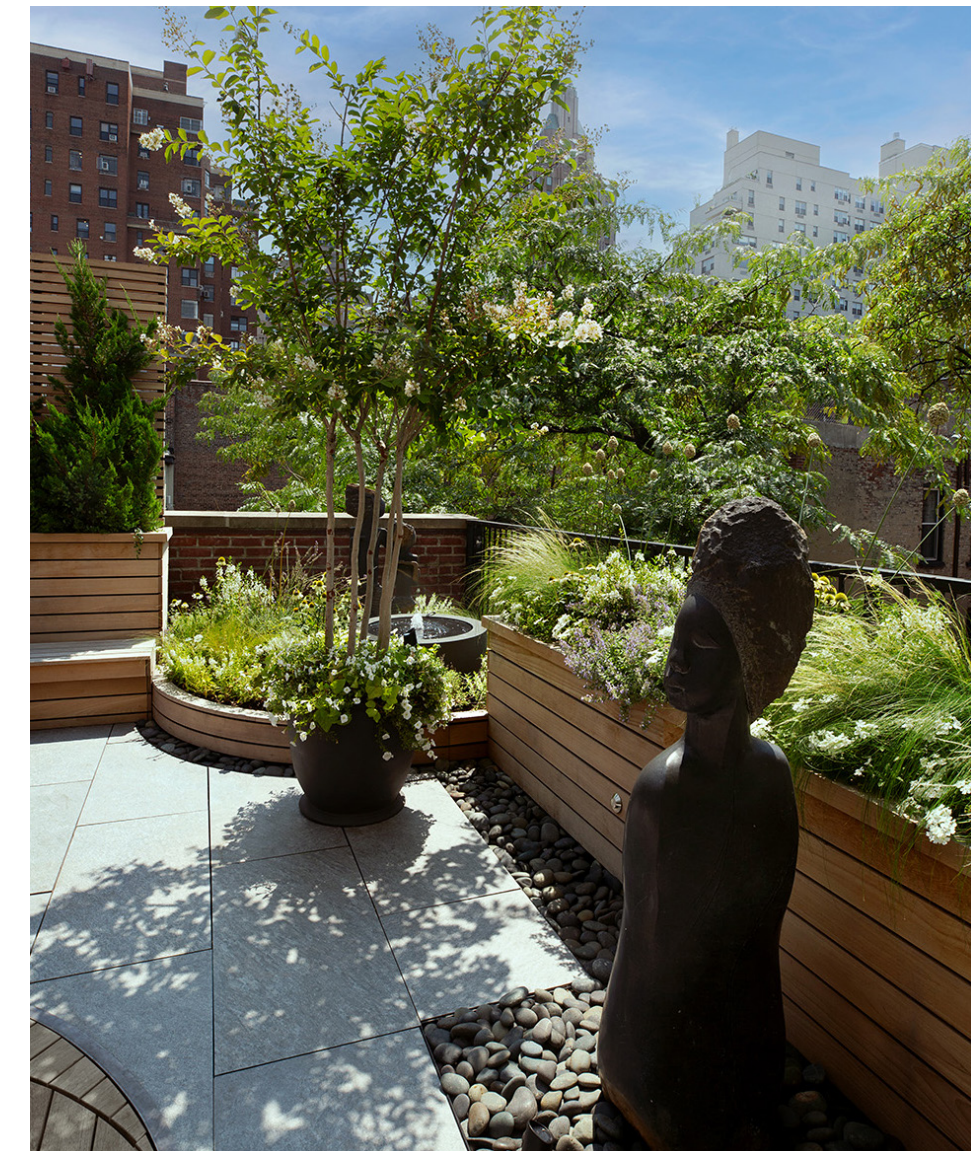

PHOTOGRAPH BY BRIAN TISZA

JUDGES' FEEDBACK:

The space has been masterfully transformed from outdated to contemporary chic. This is clearly a sophisticated use of elements that are artfully combined in a livable design. It's a beautiful space I feel I can walk in and be still. The design statement speaks to creating pollinator habitat by including native plants.



PHOTOGRAPH BY BRIAN TISZA

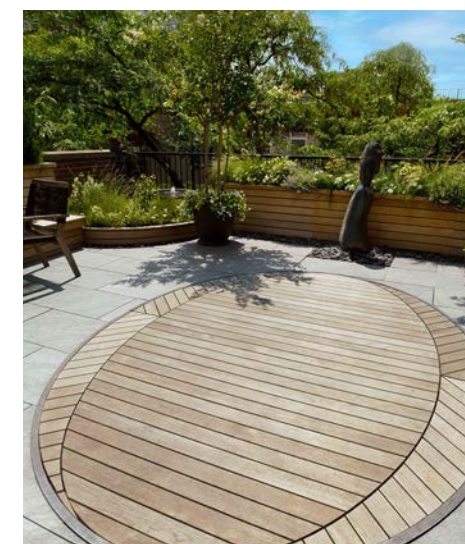

PHOTOGRAPH BY BRIAN TISZA

GREENWICH VILLAGE TERRACE

Small Gardens Category
Project Location: New York, New York
Zone: 7b

**Lauren Pucciarelli/Trillium
Landscape Design**

Website: www.nyctrillium.com
Firm Location: New York, New York

gold award



HIGHBURY

Small Gardens Category
Project Location: London, UK
Zone: 9

Adolfo Harrison Gardens

Website: www.adolfoharrison.com
Firm Location: London, UK

PHOTOGRAPHS BY MISCHA HALLER



JUDGES' FEEDBACK:

This garden is an interesting transformation. The planting and hardscape elements create texture and interest. The slanted green painted fence is subtle and adds another dimensionality. The repetition of the arch is a cohesive element, and the plant life seems to burst forth, creating a lush tropical feel.

gold award



JUDGES' FEEDBACK:

A clean, modern and contemporary feel to a historic structure, seamlessly blending the old with the new. Clean lines are represented with both the hardscape selections, repurposed from the site, and the repetition of a simple plant palette. Less is more. Serenity, a quiet space in a bustling city.

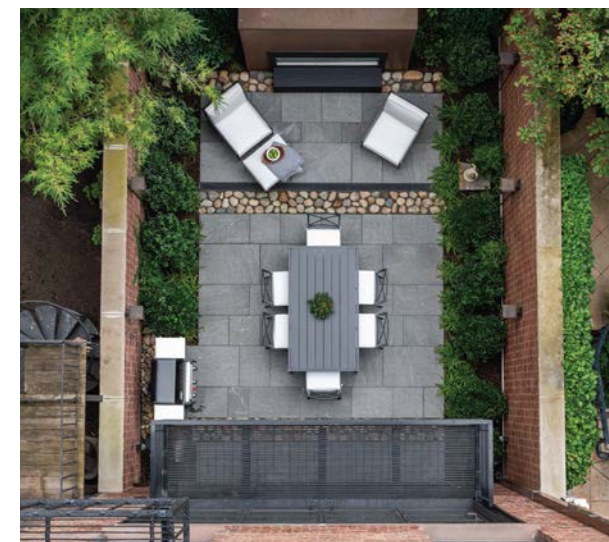

LOUISBURG SQUARE COURTYARD

Small Gardens Category

Project Location: Boston, Massachusetts

Zone: 7a

Matthew Cunningham Landscape Design LLC

Website: www.matthew-cunningham.com

Firm Location: Stoneham, Massachusetts

PHOTOGRAPHS BY NAT REA PHOTOGRAPHY

silver award



TINY COURTYARD OF HISTORIC BROWNSTONE
Small Gardens Category
Project Location: Jersey City, New Jersey
Zone: 7b

Emma Lam/ A Small Green Space

Website: www.asmallgreenspace.com
Firm Location: Jersey City, New Jersey

PHOTOGRAPHS BY MEGAN MALOY PHOTOGRAPHY

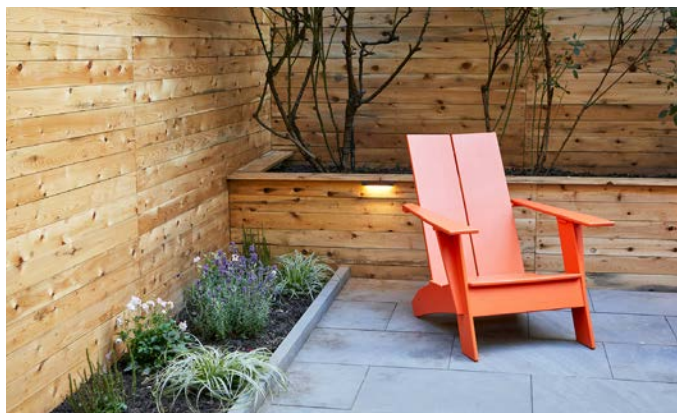

JUDGES' FEEDBACK:
The space as designed is functional, with added dimension over the existing space. The bright colors add a touch of whimsy and play.

bronze award

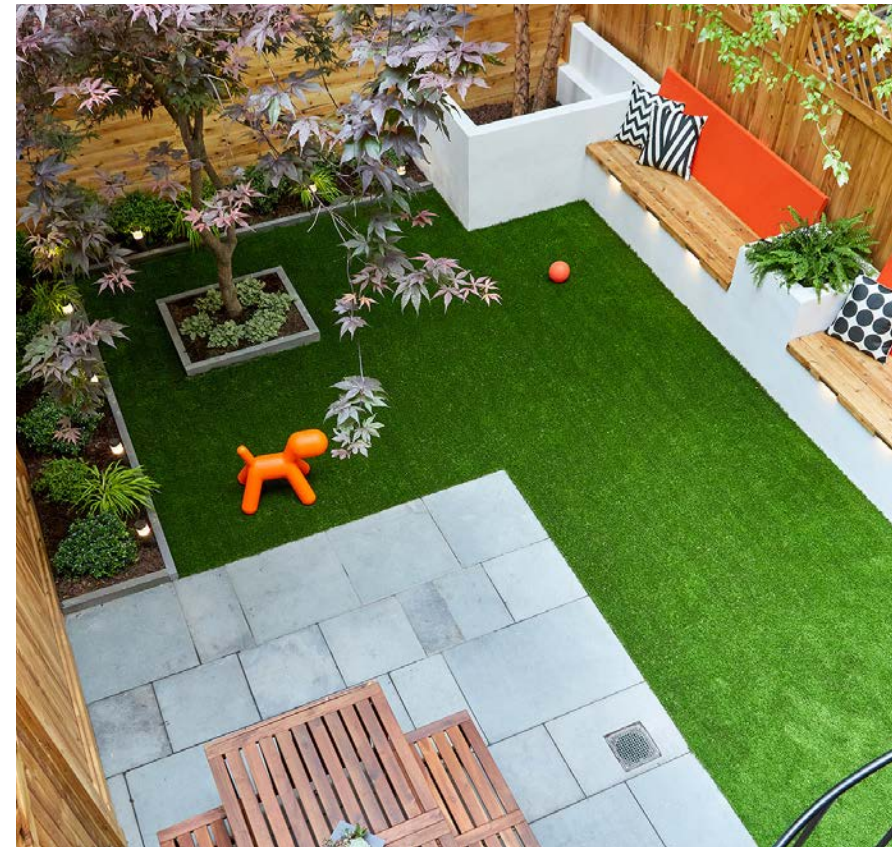

COZY CITY YARD
Small Gardens Category
Project Location: Jersey City, New Jersey
Zone: 7b

Emma Lam/ A Small Green Space

Website: www.asmallgreenspace.com
Firm Location: Jersey City, New Jersey

PHOTOGRAPHS BY MEGAN MALOY PHOTOGRAPHY



JUDGES' FEEDBACK: A solid design and nice geometries.



bronze award



SMALL TIERED CITY SPACE
Small Gardens Category
Project Location: Jersey City, New Jersey
Zone: 7b

Emma Lam/ A Small Green Space

Website: www.asmallgreenspace.com
Firm Location: Jersey City, New Jersey

PHOTOGRAPHS BY MEGAN MALOY PHOTOGRAPHY



2024 award winners

Specialty Projects



gold award



PHOTOGRAPH BY LOUIS SANCHES

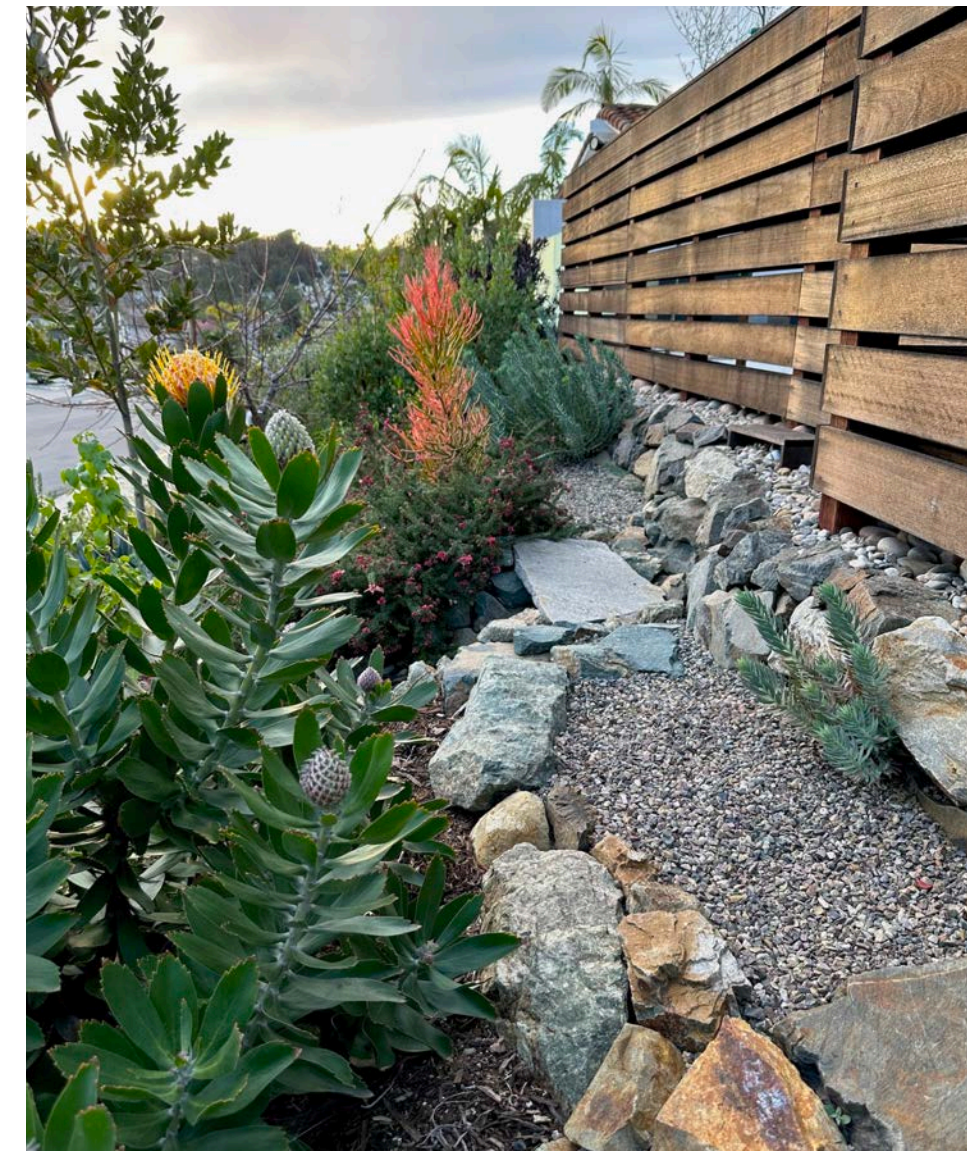

PHOTOGRAPH BY LAURA LISAUSKAS

JUDGES' FEEDBACK:
A transformation from a blank space to a vibrant canvas of life. Elements are incorporated with a creative approach.



PHOTOGRAPH BY LAURA LISAUSKAS



PHOTOGRAPH BY LAURA LISAUSKAS



PHOTOGRAPH BY LAURA LISAUSKAS

CERRO BOTANICAL GARDEN
Specialty Projects Category
Project Location: Encinitas, California
Zone: 10b

Laura Lisauskas/LLD Landscape Design

Website: www.lld-landscape-design.com
Firm Location: Encinitas, California

gold award



EXQUISITE GARDEN GETAWAY

Specialty Projects Category
Project Location: McLean, Virginia
Zone: 6a

EBLA

Website: www.ebla.pro
Firm Location: Oak Hill, Virginia

PHOTOGRAPHS BY GEORGE BROWN PHOTOGRAPHY

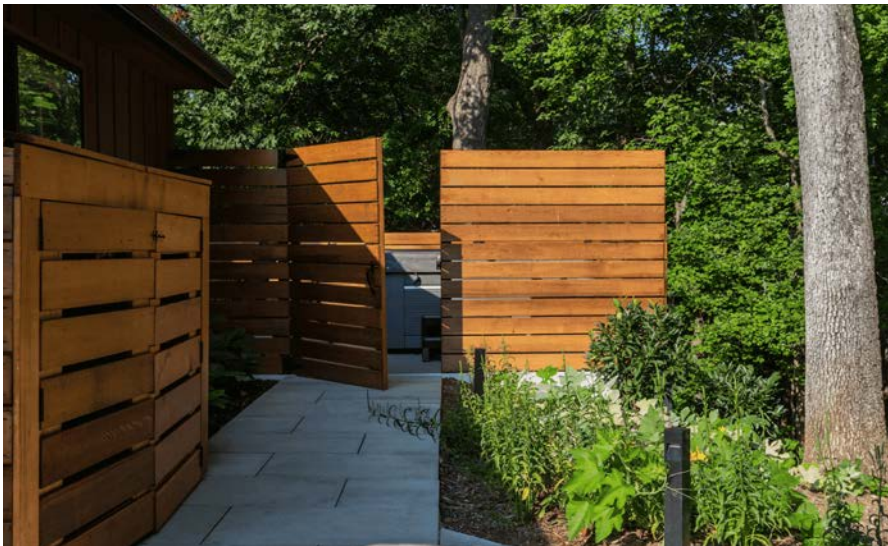

JUDGES' FEEDBACK:
The design adds depth and interest to the entry. There is a repetition and flow that visually expands the space. Terracing, a larger welcoming space with the addition of veggies, creates an opportunity for the homeowner and the neighbors to engage with each other.

gold award



JUDGES' FEEDBACK:

In many ways this is a simple yet complex design. The layering and interplay of trees, shrubs, perennials, and grasses is more than just pleasing to the eye. The design affords movement, as well as habit, while capturing and infiltrating run-off. The dense planting is a welcome relief from what was a monoculture lawn, which afforded no biological life or rainwater infiltration.

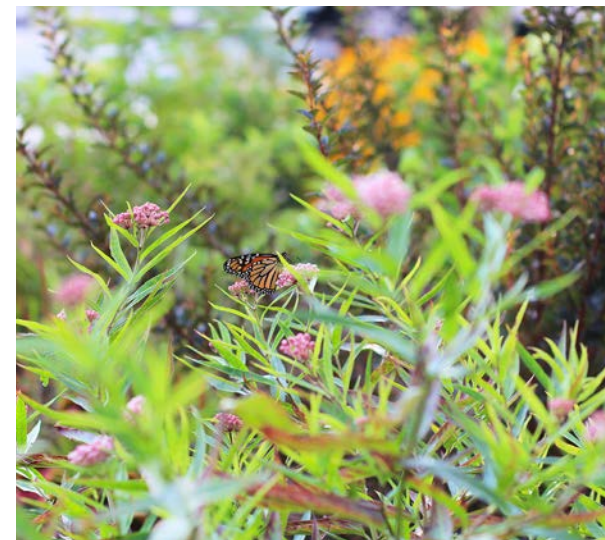

THE BIG PICTURE

Specialty Projects Category
Project Location: Bala Cynwyd, Pennsylvania
Zone: 7b

Refugia Design

Website: www.refugiadesign.com
Firm Location: Narberth, Pennsylvania

silver award

SAMMAMISH PINES RESIDENCE

Specialty Projects Category
Project Location: Sammamish, Washington
Zone: 7b-8b

Northwest Outdoor Lighting

Website: www.nwoutdoorlighting.com
Firm Location: Woodinville, Washington

PHOTOGRAPHS BY LAURIE ASCANIO

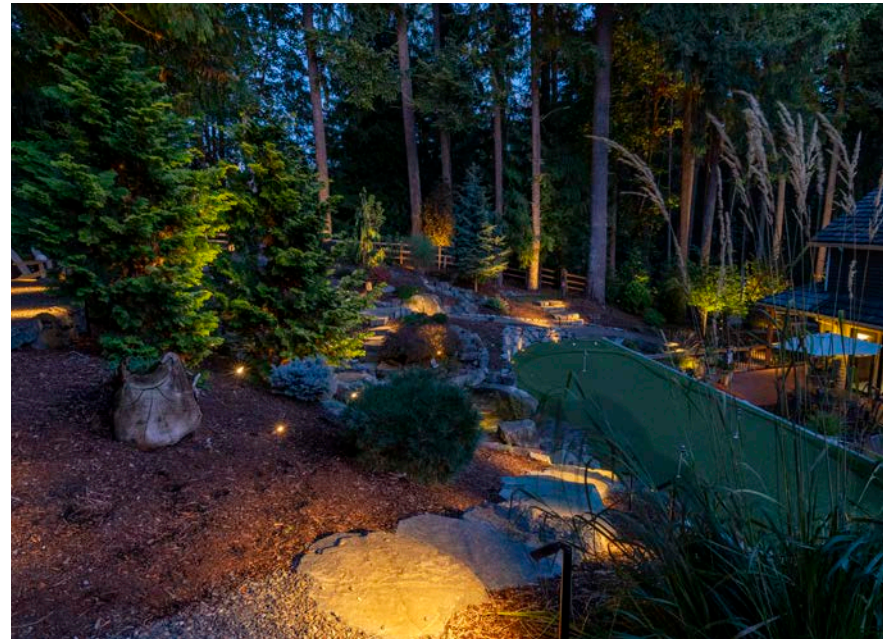

JUDGES' FEEDBACK:

The design functions to illuminate and open the area up at night for egress and safety. LED is a wonderful alternative to the halogen lighting of the past.

staff

Executive Director

Denise R. Calabrese, CAE
info@apld.org

Communications Director

Michelle Keyser
communications@apld.org

Communications Manager

Courtney Kuntz
comm@apld.org

contact us

Association of Professional Landscape Designers

2207 Forest Hills Drive
Harrisburg, PA 17112
Phone: 717-238-9780
Fax: 717-238-9985
Website: www.apld.org
Office Hours: Monday through Friday
8:30 a.m. - 5 p.m. Eastern Time



APLD 2024 Board of Directors

Executive Committee

President

Bill Ripley, CPLD, FAPLD
Stride Studios
8525 Miami Road
Cincinnati, OH 45243
(513) 984-4882
bill@stridestudios.com

President-Elect

Katie Weber, CPLD
Katie Weber Landscape Design
5637 45th Avenue SW
Seattle, WA 98136
(206) 391-8894
katie@katiweberlandscapedesign.com

Treasurer

Lisa Nunamaker, PLA
Iowa State University
Dept of Horticulture
129 Horticulture Hall
Ames, IA 50011
(515) 509-4119
lisa@papergardenworkshop.com

Immediate Past President

Richard Rosiello
Rosiello Designs &
Meadowbrook Gardens
159 Grove Street
New Milford, CT 06776
(860) 488-6507
rosiellodesigns@gmail.com

Directors

Francesca Corra, CPLD
Dirt Diva Designs
4030 Cartwright Avenue
Studio City, CA 91604
(818) 370-3200
fcorra@aol.com

Linda Middleton, CPLD, FAPLD
Terralinda Design
1839 Ygnacio Valley Rd.,
#150
Walnut Creek, CA 94598
(925) 448-2441
linda@terralindadesign.com

Mardi Dover, CPLD
15 Warwick Place
Asheville, NC 28804
(828) 273-5134
mardi@gardensbymardi.com

Maryanne Quincy, CPLD, FAPLD
Q Gardens Landscape Design
PO Box 2746
Sunnyvale, CA 94087
(408) 739-5493
qgardens@sbcglobal.net

Rachel Gioannini
2046 Cortabella
Las Cruces, NM 88005
(520) 955-1861
rachelgi@nmsu.edu

